

TYPE A - WIDE FLANGE POST

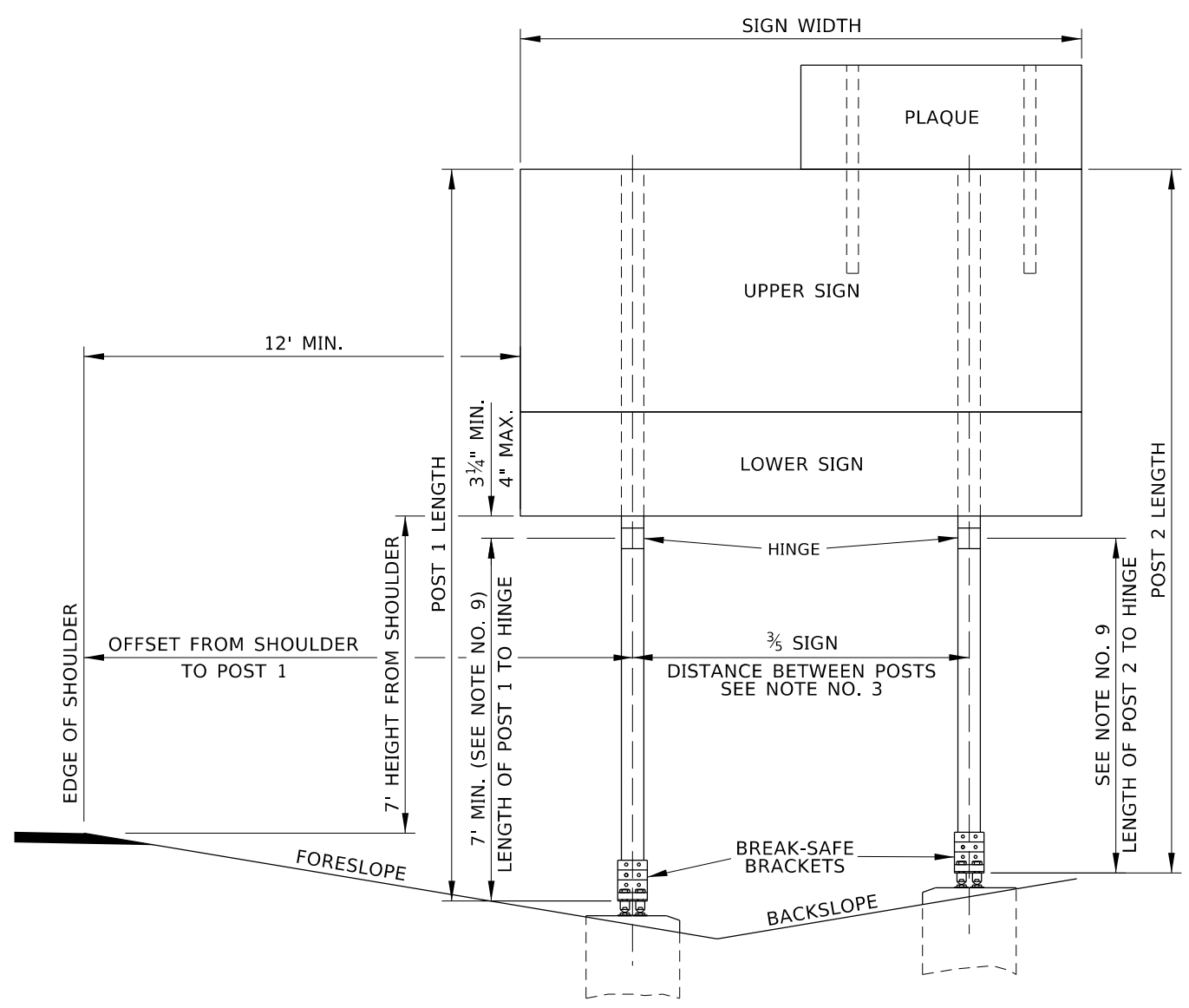

TWO POSTS

SIGN ASSEMBLY MEASUREMENTS

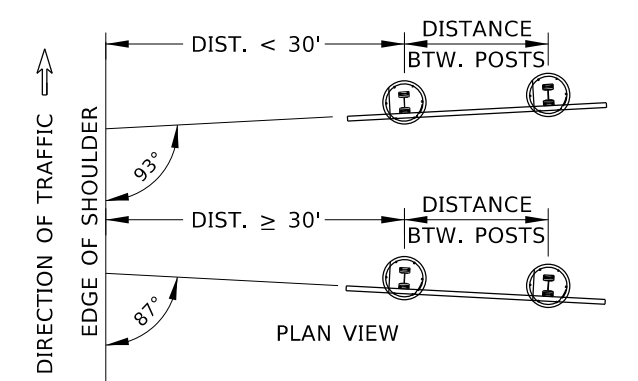

SIGN ORIENTATION

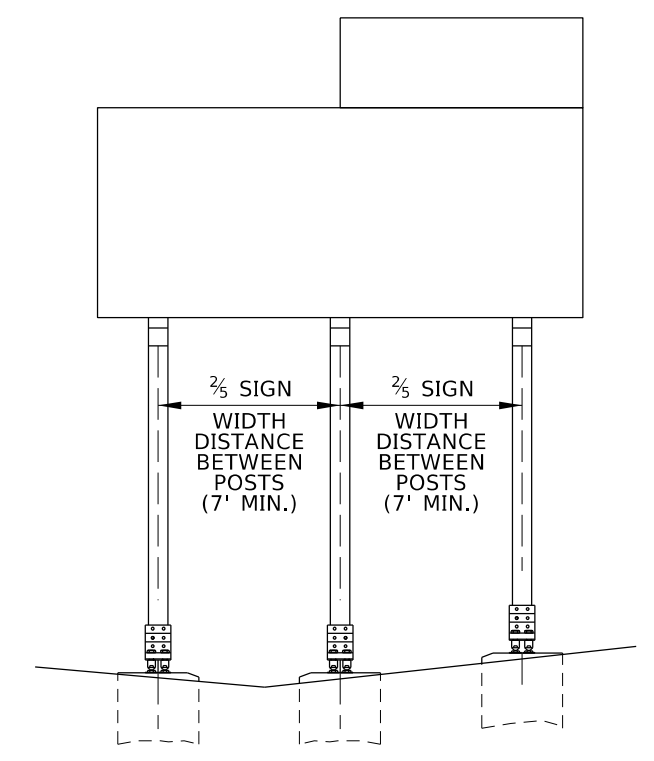

THREE POSTS

SIGN POST, FOUNDATION, AND TEMPLATE TABLE

TYPE A WIDE FLANGE POST													FOUNDATION						TEMPLATE					
POST TYPE	WIDE FLANGE POST SIZE	WEIGHT (LB/FT)	MAXIMUM SIGN LOAD PER POST (SFxFT)	BREAK-SAFE MODEL NUMBER	A (IN)	B (IN)	C (IN)	D (IN)	E (IN)	F (IN)	G (IN)	H (IN)	J (IN)	SIZE (DIAxDEPTH) (INxIN)	CONCRETE (CY)	VERTICAL REINFORCING STEEL BAR SIZE	NUMBER OF BARS	LENGTH (FT)	REINFORCING STEEL HOOPS BAR SIZE	NUMBER OF BARS	LENGTH (FT)	K (IN)	L (IN)	M (IN)
A-1	W6x9	9	620	AI6	1 1/16	1 7/16	2 1/16	-	9/16	5/8	1 5/8	1 1/8	9/16	24x60	0.6	4	6	26	4	4	21	9 5/8	36	4 1/4
A-2	W8x10	10	870	B525	1 1/8	3/4	1 7/8	1 3/4	9/16	7/8	1 7/8	3/4	1 3/16	30x84	1.3	4	6	38	4	4	28	15 7/8	40	3
A-3	W8x13	13	1,100	B525	1 1/8	3/4	1 7/8	1 3/4	9/16	7/8	1 7/8	3/4	1 3/16	30x84	1.3	4	6	38	4	4	28	16	40	3
A-4	W8x18	18	1,700	B525	1 1/8	3/4	1 7/8	1 3/4	9/16	7/8	1 7/8	3/4	1 3/16	30x84	1.3	4	6	38	4	4	28	16 1/8	40	3
A-8	W12x19	19	2,370	B650	1 1/8	3/4	1 7/8	1 3/4	1 1/16	7/8	1 7/8	3/4	1 3/16	36x96	2.1	4	8	60	4	5	42	20 1/8	48	4
A-9	W14x22	22	3,200	B650	1 1/8	3/4	1 7/8	1 3/4	1 1/16	7/8	1 7/8	3/4	1 3/16	36x96	2.1	4	8	60	4	5	42	21 3/4	48	4

ORIGINAL STORED AT: ITD, Headquarters 3311 West State Boise, Idaho

REVISIONS								
NO.	DATE	BY	NO.	DATE	BY	NO.	DATE	BY
1	03-21	RDL						
2	02-23	RDL						

SCALES SHOWN ARE FOR 11" X 17" PRINTS ONLY
 CADD FILE NAME: 616-5_0423.dgn
 DRAWING DATE: DECEMBER, 2016

IDAHO TRANSPORTATION DEPARTMENT
 YOUR Safety → YOUR Mobility → YOUR Economic Opportunity
BOISE IDAHO

ORIGINAL SIGNED BY: MONICA CRIDER
 HIGHWAY DESIGN ENGINEER

STANDARD DRAWING
STEEL SIGN POST AND FOUNDATION
 TYPE A - WIDE FLANGE POST

ENGLISH
 STANDARD DRAWING NO. 616-5
 SHEET 1 OF 2

PROFESSIONAL ENGINEER
 RYAN D. LANCASTER
 LICENSE NO. 3683
 STATE OF IDAHO
 ORIGINAL SIGNED BY: RYAN D. LANCASTER
 DATE: MARCH 1, 2016

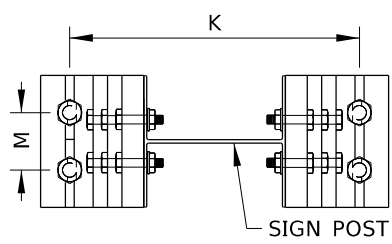

PLAN VIEW

BREAK-SAFE BRACKET DETAIL

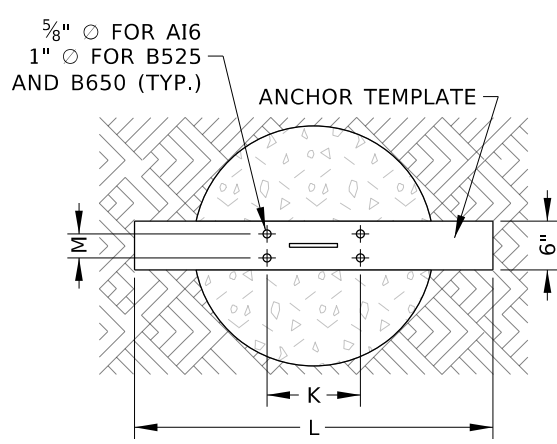

PLAN VIEW

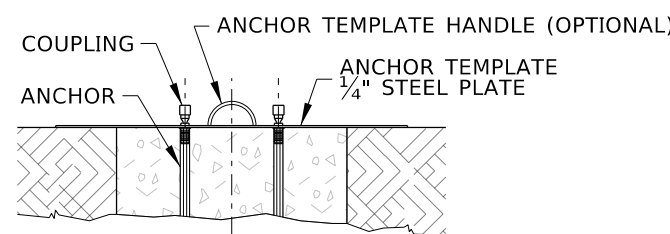

ELEVATION

TEMPLATE DETAIL

SEE NOTE NO. 3

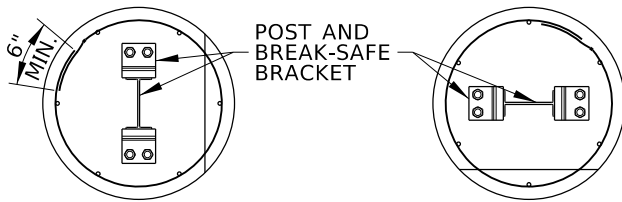

PLAN VIEW

PLAN VIEW

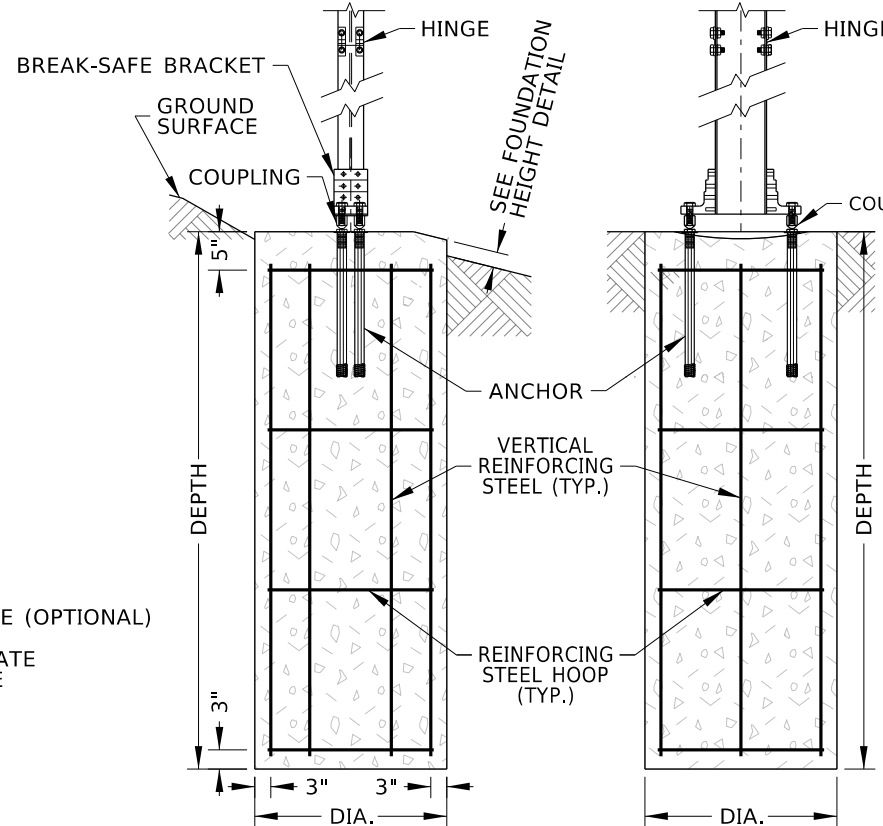

ELEVATION FRONT VIEW

ELEVATION SIDE VIEW

FOUNDATION

SEE NOTE NOS. 8 & 9

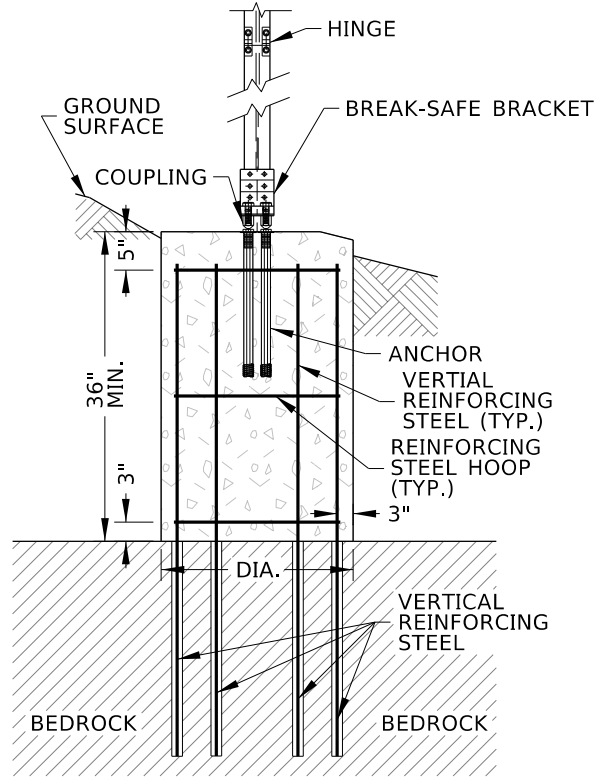

ELEVATION FRONT VIEW

ALTERNATE FOUNDATION

SEE NOTE NO. 9

ALTERNATE FOUNDATION TABLE				
SIZE (DIAxDEPTH) (INxIN)	CONCRETE (CY)	REINFORCING STEEL HOOPS*		
		BAR SIZE	NUMBER OF BARS	LENGTH (FT)
24x36	0.35	4	4	16
30x36	0.55	4	4	21
36x36	0.80	4	4	25

* SEE SIGN POST, FOUNDATION, AND TEMPLATE TABLE FOR VERTICAL REINFORCING STEEL.

NOTES

- USE TYPE A - WIDE FLANGE POSTS - WITH TYPE C - EXTRUDED ALUMINUM PANEL SIGNS.
- SEE THE TRAFFIC MANUAL TO CALCULATE SIGN LOAD PER POST.
- USE BREAK-SAFE BREAKAWAY SUPPORT SYSTEM WITH TYPE A - WIDE FLANGE POSTS. FOLLOW THE MANUFACTURER'S INSTRUCTIONS. FABRICATE AND USE AN ANCHOR TEMPLATE TO ENSURE CORRECT ANCHOR PLACEMENT.
- SEE PROJECT SIGN SUMMARY FOR SIGN ASSEMBLY DIMENSIONS.
- USE TWO OR THREE TYPE A - WIDE FLANGE POSTS. DO NOT INSTALL ONLY ONE TYPE A - WIDE FLANGE POST. DO NOT MIX POST SIZES ON THE SAME SIGN ASSEMBLY.
 - A. TWO POST SIGNS:
 - I. FOR SIGNS NARROWER THAN 6' WIDE, PROVIDE MORE THAN 3/5 SPACING BETWEEN POSTS.
 - II. PROVIDE A MINIMUM 7' DISTANCE BETWEEN POST TYPES A-8 AND A-9.
 - B. THREE POSTS: PROVIDE 7' MIN. BETWEEN POSTS.
- POST 1 IS CLOSEST TO THE HIGHWAY, WHETHER INSTALLED ON THE RIGHT OR LEFT SIDE.
- TYPE A - WIDE FLANGE POSTS (WITH THE BREAK-SAFE BREAKAWAY SUPPORT SYSTEM SHOWN) DO NOT NEED TO BE SHIELDED BY GUARDRAIL OR BARRIER. WHEN WIDE FLANGE POSTS ARE INSTALLED BEHIND GUARDRAIL OR BARRIER, ENSURE THE POSTS ARE OUTSIDE OF THE GUARDRAIL OR BARRIER WORKING WIDTH.
- CAST FOUNDATION IN NATIVE SOILS IN AN AUGURED HOLE. IF AN AUGURED HOLE IS IMPRACTICAL, CAST THE FOUNDATION IN A CORRUGATED METAL PIPE FORM AND BACKFILL IN ACCORDANCE WITH SECTION 210.
- IF SOLID BEDROCK IS ENCOUNTERED WITHIN THE FOUNDATION DEPTH, USE THE ALTERNATE FOUNDATION. QUANTITIES SHOWN FOR THE ALTERNATE FOUNDATION ASSUME 36" DEPTH TO BEDROCK. SOCKET VERTICAL REINFORCING STEEL FOR THE DEPTH SHOWN IN THE FOUNDATION MATERIAL QUANTITIES. DRILL 2 INCH MINIMUM DIAMETER HOLES. FILL DRILLED HOLES WITH GROUT, TYPE B, CLASS 1. NOTIFY THE ENGINEER IF THE DEPTH TO SOLID BEDROCK IS LESS THAN 36". IF LESS THAN 36", REDESIGN OF THE FOUNDATION MAY BE REQUIRED.
- EXCEPT ON 2:1 OR STEEPER BACKSLOPES, THE LENGTH OF POSTS WITHIN THE HIGHWAY CLEAR ZONE MUST BE 7' OR LONGER FROM THE BREAKAWAY SYSTEM TO THE HINGE. POSTS OUTSIDE OF THE HIGHWAY CLEAR-ZONE OR ON BACKSLOPES 2:1 OR STEEPER CAN BE SHORTER THAN 7'. WHEN SHORTER THAN 7', ENSURE THE SIGN IS AT LEAST 5' HIGHER THAN THE GROUND SURFACE, OR 1' HIGHER THAN THE GROUND SURFACE IF THE SIGN WILL NOT BE OBSCURED BY VEGETATION.
- ENSURE NO PART OF THE FOUNDATION OR STUB OF BREAKAWAY SYSTEM PROJECT MORE THAN 4 IN. ABOVE ANY 5 FT. CHORD ALIGNED PERPENDICULARLY TO THE EDGE OF THE HIGHWAY BETWEEN A POINT ON THE GROUND SURFACE ON ONE SIDE OF THE SUPPORT TO A POINT ON THE GROUND SURFACE ON THE OTHER SIDE OF THE SUPPORT.
- CENTER SIGN BETWEEN POSTS
- DO NOT INSTALL SIGNS BELOW THE HINGES.
- DRAWING NOT TO SCALE.

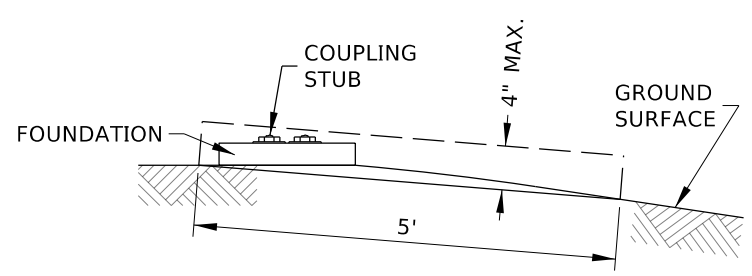

BREAK-SAFE COUPLING STUB HEIGHT DETAIL

SEE NOTE NO. 11

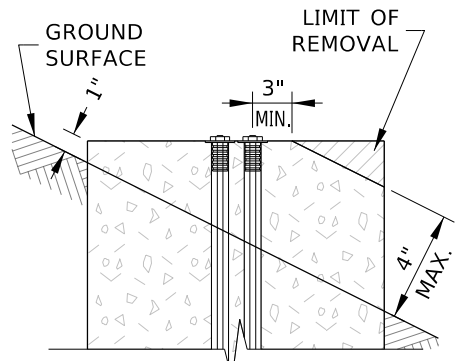

FOUNDATION HEIGHT DETAIL

SEE NOTE NO. 11

REVISIONS								
NO.	DATE	BY	NO.	DATE	BY	NO.	DATE	BY
1	03-21	RDL						
2	02-23	RDL						

SCALES SHOWN ARE FOR 11" X 17" PRINTS ONLY
 CADD FILE NAME: 616-5_0423.dgn
 DRAWING DATE: DECEMBER, 2016

IDAHO TRANSPORTATION DEPARTMENT
 YOUR Safety → YOUR Mobility → YOUR Economic Opportunity
 BOISE IDAHO

ORIGINAL SIGNED BY: MONICA CRIDER
 HIGHWAY DESIGN ENGINEER

STANDARD DRAWING
STEEL SIGN POST AND FOUNDATION
 TYPE A - WIDE FLANGE POST

ENGLISH
 STANDARD DRAWING NO.
616-5
 SHEET 2 OF 2

ORIGINAL STORED AT: ITD, Headquarters 3311 West State Boise, Idaho

PROFESSIONAL ENGINEER
 RYAN D. LANCASTER
 LICENSE NO. 3683
 STATE OF IDAHO