

CONSTRUCTION

This project is currently in the design phase. ITD will know more about construction impacts once design plans are finalized.

AT THIS TIME, ITD ANTICIPATES:

- **Construction of the Snake River Bridge and Idaho 55 improvements will begin in 2017.**
- **One lane will be open for traffic over the bridge during construction.**
 - **Lane widths during construction will vary between 14 and 19 feet.**
- **One lane of traffic will be open in both directions between Marsing and the U.S. 95 junction.**
- **Construction of the bridge will occur in two stages.**



CONSTRUCTION PHASING

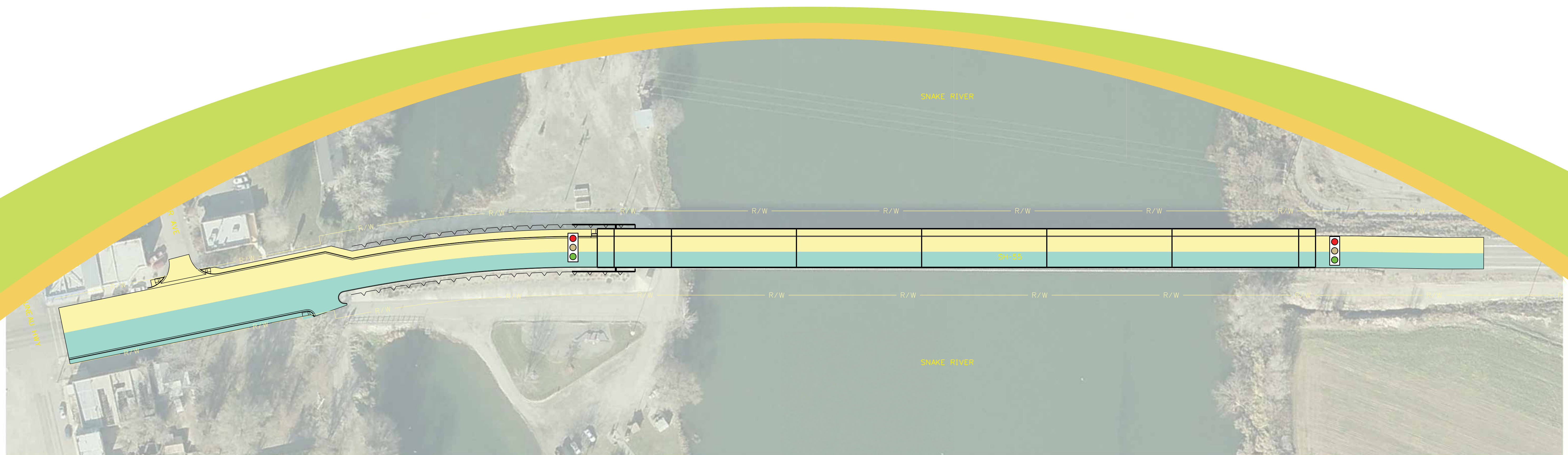
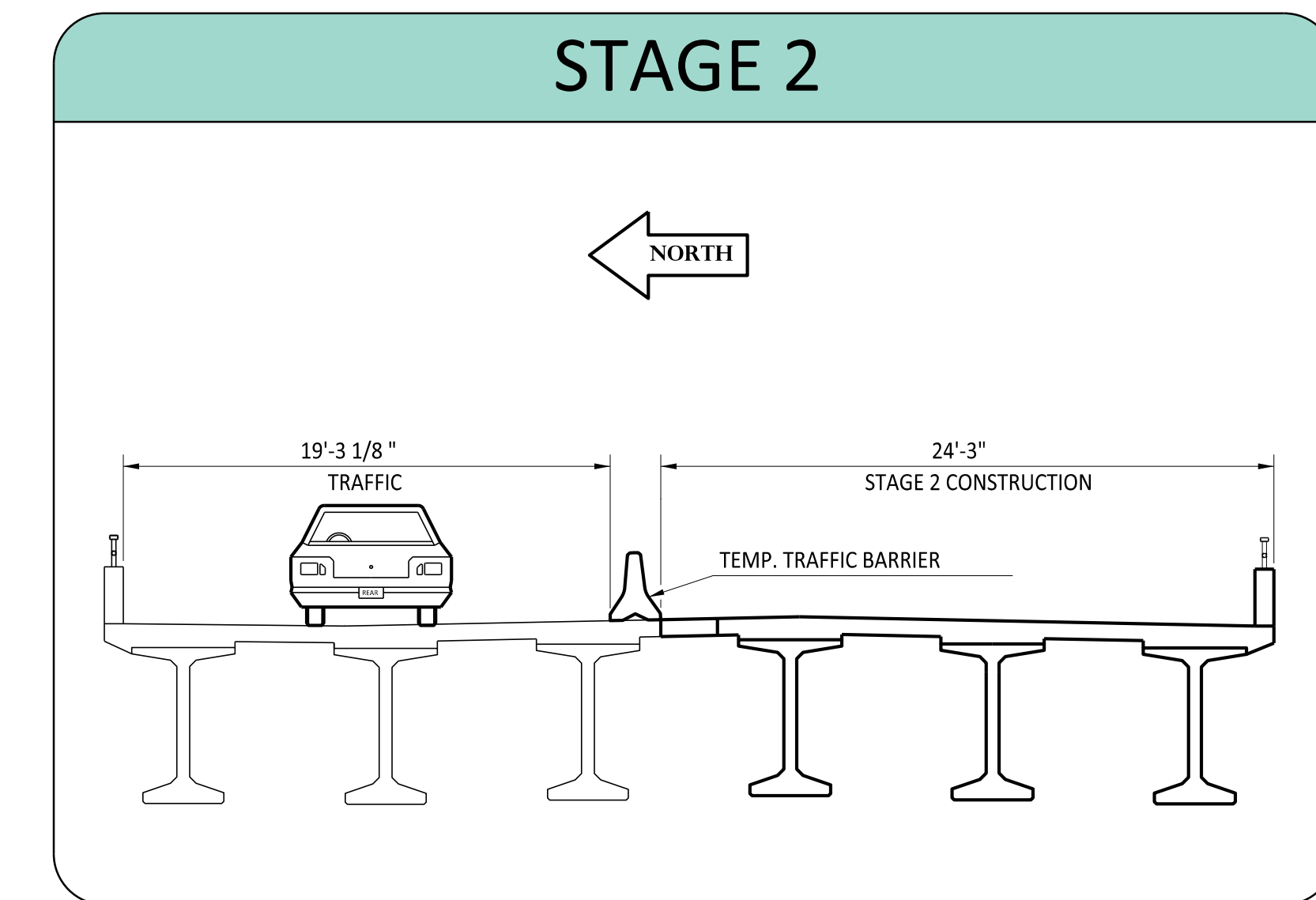
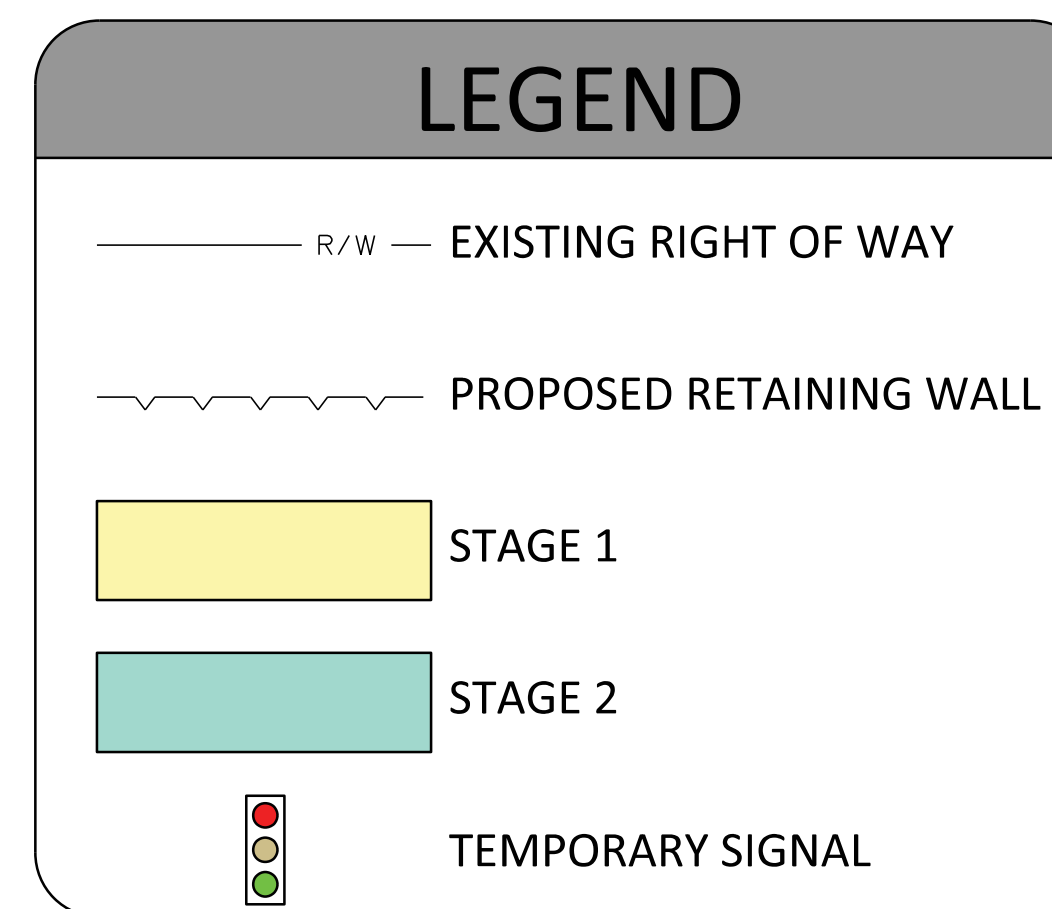
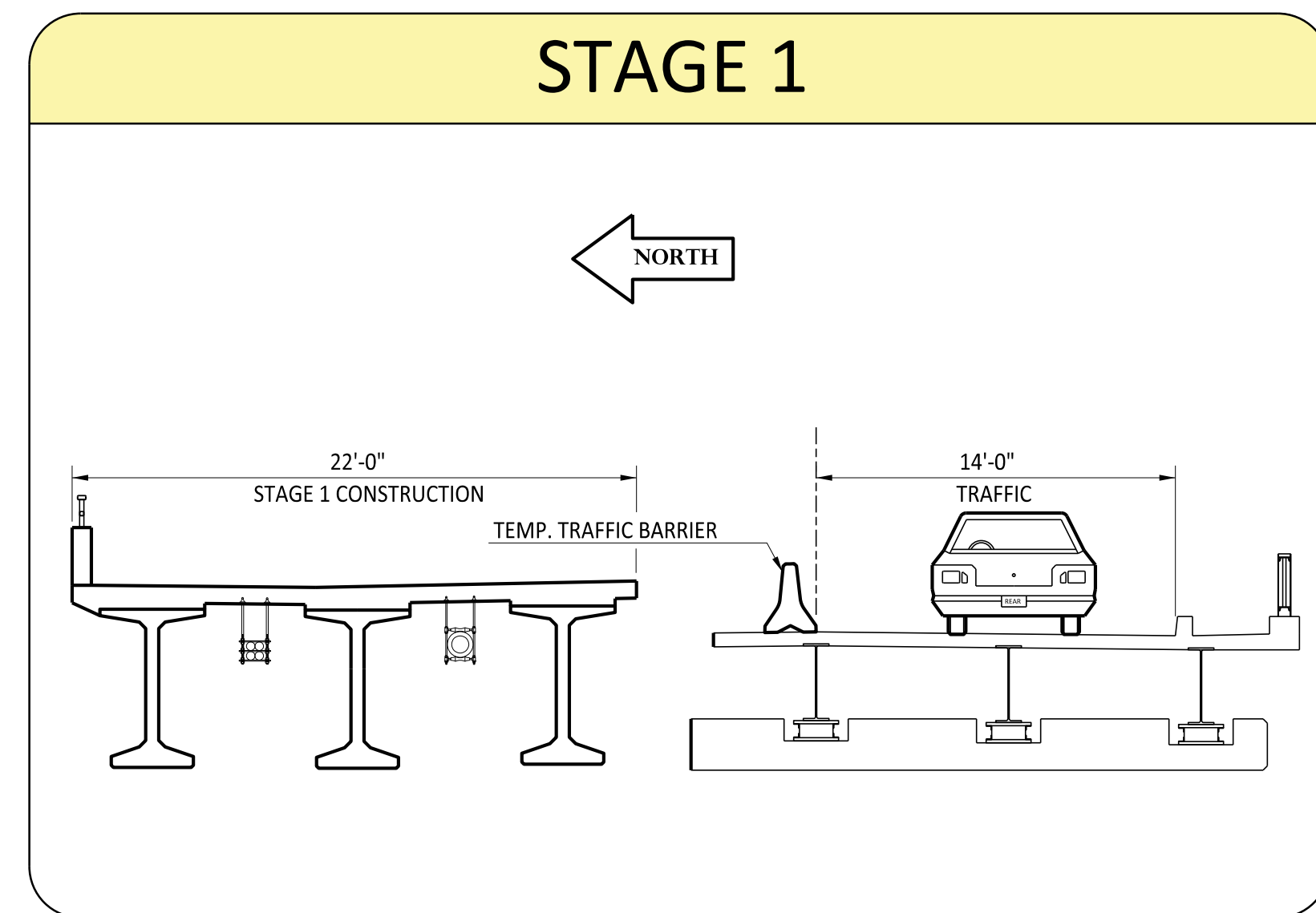

Scale (Feet)
60 0 60 120 Horiz.



PROJECT NO. A013(387)

KEY NO. 13387

T-O ENGINEERS

**SH-55 SNAKE RIVER
BRIDGE MARSING**

AUGUST 2015

ADDITIONAL RIVER CROSSINGS

OREGON IDAHO

