

# US 20/26 CORRIDOR STUDY

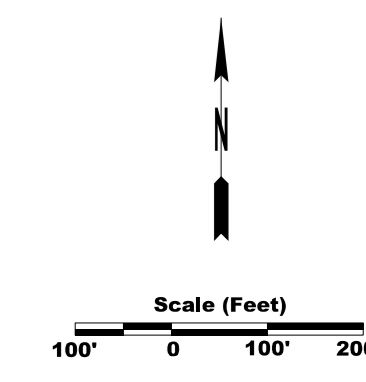

- LEGEND**
- PROPOSED RIGHT-OF-WAY
  - ROADWAY LAYOUT
  - MULTI-USE PATHWAY OR SIDEWALK
  - PROPOSED CURB
  - 230 KV POWER POLE
  - PROPERTY LINE
  - HISTORIC FEATURE BOUNDARY
  - WETLAND BOUNDARY

MATCH LINE, SEE SHEET 2

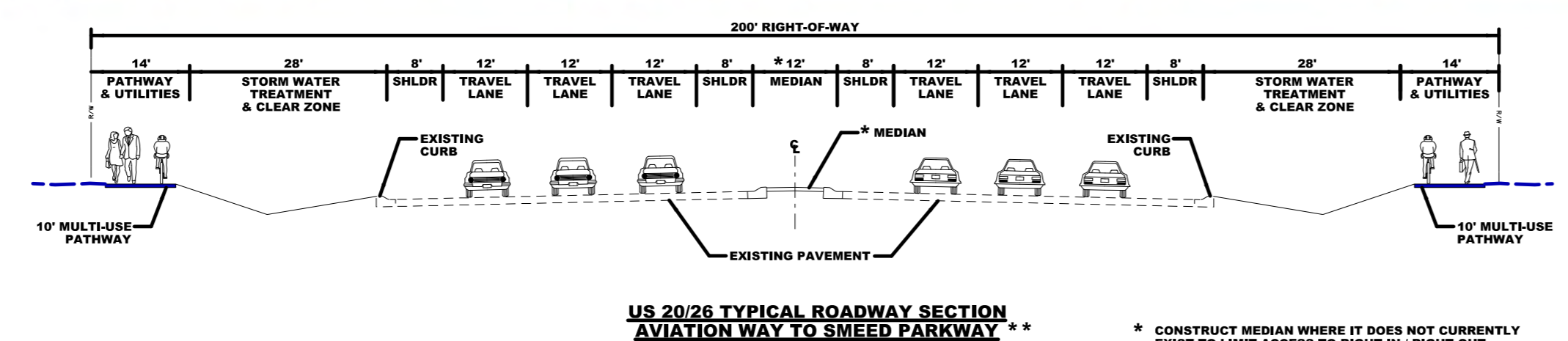
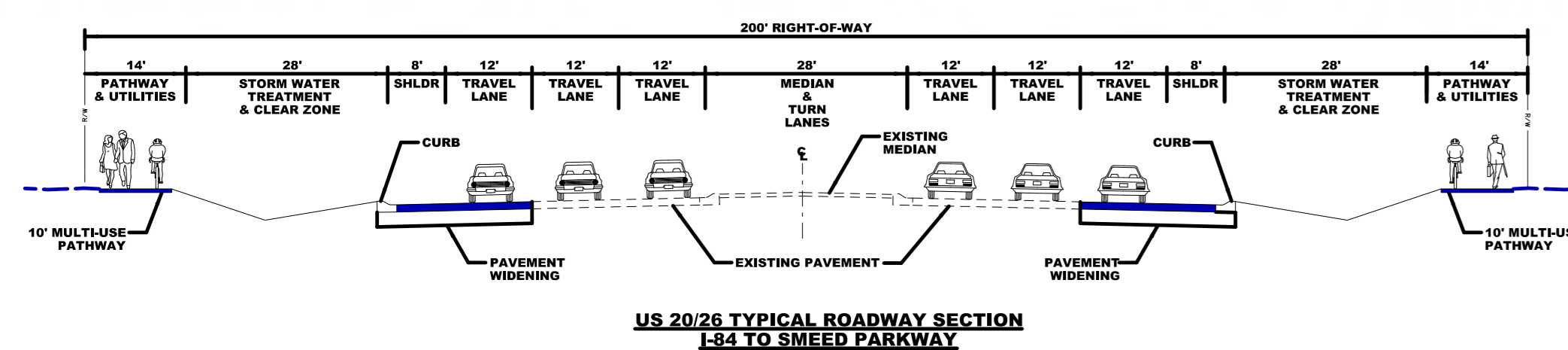

\* CONSTRUCT MEDIAN WHERE IT DOES NOT CURRENTLY EXIST TO LIMIT ACCESS TO RIGHT-IN / RIGHT-OUT  
\*\* SEE SHEET #2 FOR TYPICAL SECTION EAST OF SMEED PARKWAY

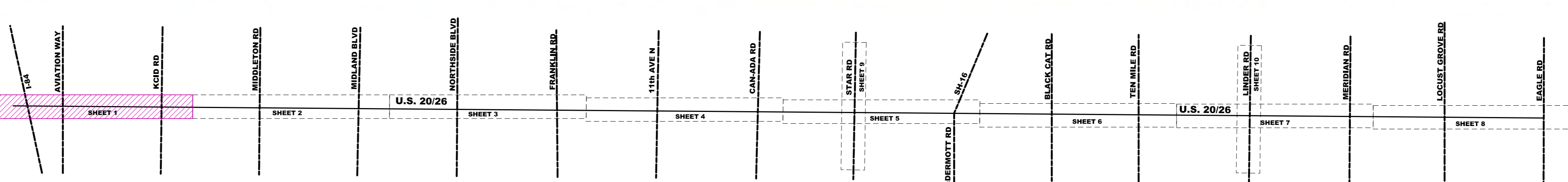

**Parametrix**  
TRANSPORTATION & ENVIRONMENTAL SCIENCES  
700 W. PROGRESS DRIVE, SUITE 200 • BOZEMAN, MT 59717  
P. 406.593.6022  
WWW.PARAMETRIX.COM

PROJECT NO. STP-3230(106)  
KEY NO. 07826

**US 20/26 CORRIDOR STUDY  
CONCEPT LAYOUT**

**JUNE 2015**

SHEET  
1  
OF  
10