

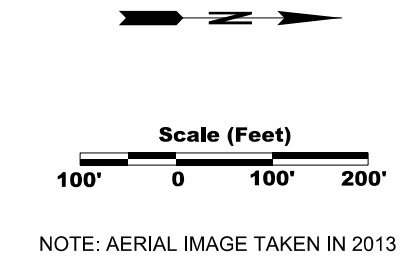

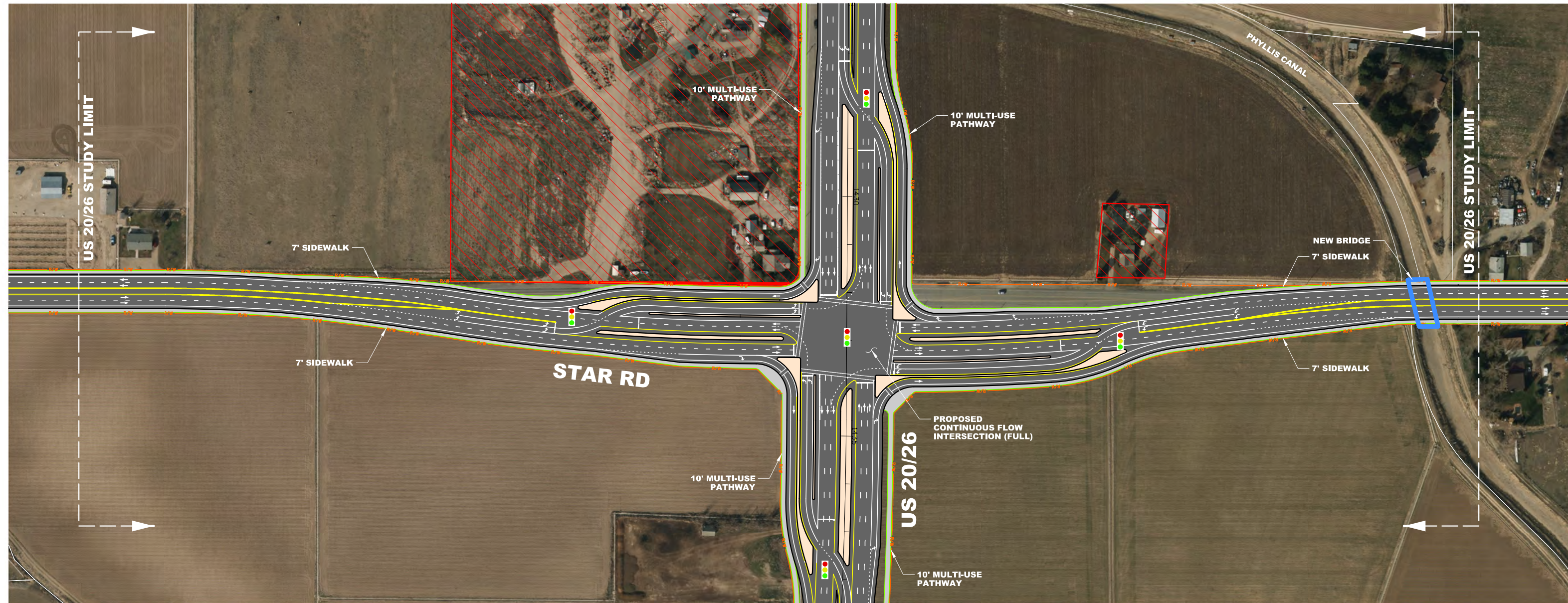

US 20/26 CORRIDOR STUDY

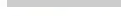

LEGEND

-  PROPOSED RIGHT-OF-WAY
-  ROADWAY LAYOUT
-  MULTI-USE PATHWAY OR SIDEWALK
-  PROPOSED CURB
-  230 KV POWER POLE
-  PROPERTY LINE
-  HISTORIC FEATURE BOUNDARY
-  WETLAND BOUNDARY

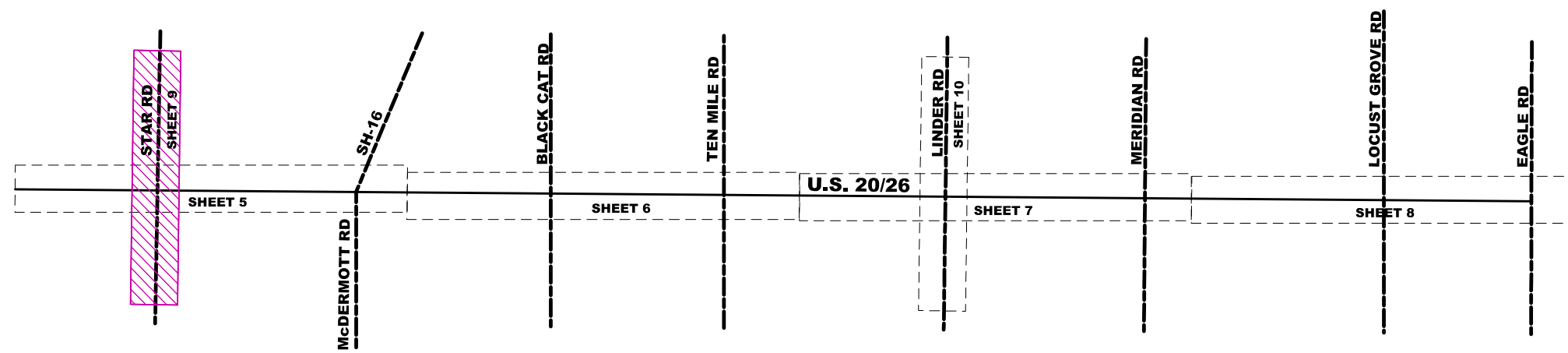

PLAN LOCATION



Parametrix
 ENGINEERING · PLANNING · ENVIRONMENTAL SCIENCES
 7761 W RIVERSIDE DRIVE, SUITE 201 | BOISE, ID 83714
 P 208.898.0012
 WWW.PARAMETRIX.COM
 PROJECT NO. STP-3230(106)
 KEY NO. 07826

**US 20/26 CORRIDOR STUDY
 CONCEPT LAYOUT**

JUNE 2015

SHEET
 9
 OF
 10