



ITD District 3 Improvements

Prebid RFI Log

Last Updated: 5/17/2024

A - Miscellaneous									
Item #	Date Created:	Created By:	Description	Response Due:	Response from:	Response Rec'd:	Response Detail:	Status	Comments

B - Civil/Landscape									
Item #	Date Created:	Created By:	Description	Response Due:	Response from:	Response Rec'd:	Response Detail:	Status	Comments
B-1	05/02/24	SS	Irrigation water service for new irrigation system, where is the point of connection? Please clarify.	5/16/2024			CSHQA: Point of connection to be located near hose bib located adjacent to the Training Entry Door 116C	Closed	
B-2	05/13/24	SS	Where will the irrigation controller be located? Please clarify.	5/16/2024	SS		Assume controller will be located on a wall at the new training room entry way.	Closed	

C - Structural									
Item #	Date Created:	Created By:	Description	Response Due:	Response from:	Response Rec'd:	Response Detail:	Status	Comments
C-1	04/18/24	SS	Improvement Plan Set, is SW-6 shown on the Wood Shearwall Schedule used on this project?				CSHQA: No Shear walls on the Building Improvement Package.	Closed	
C-2	05/13/24	SS	Please provide the depth / elevation of the existing elevator pit.	5/16/2024			CSHQA: SEE EXISTING DRAWINGS PROVIDED IN ADDENDUM 02	Closed	
C-4	05/14/24	SS	Reference details 1 and 2 on S1.04. Please provide quantities or spacing for where the elevator pit slab connects to the existing foundation as well as the top of elevator wall running adjacent to the existing concrete wall.	5/16/2024	SS		Assume 18" O.C. for embedded reinforcing steel.	Closed	
C-5	05/14/24	SS	Reference detail 2 on A71 and note 07 33-06 on 2/A10. Please confirm that the dotted line is the slab on grade for the stair landing. Also please provide concrete landing thickness.	5/16/2024			CSHQA: DASHED LINE INDICATED LINE OF CANOPY ABOVE. SEE DETAILS 1&2/A71 FOR EXTENT OF 4" CONCRETE LANDING. SEE STRUCTURAL FOR REQUIRED STAIR FOOTING.	Closed	
C-6	05/14/24	SS	Reference detail 2/A51 and detail 6/A72. Sheet note 02 01-52 calls for the doorways to be patched/infilled. Please confirm that detail 6/A72 applies in these two areas or will these be poured back with concrete?	5/16/2024			CSHQA: DETAIL 6/A72 APPLYS TO ALL AREAS THAT WILL NEED TO BE PATCHED AND INFILLED IN THE CONCRETE WALL.	Closed	

D - Mechanical/Plumbing									
Item #	Date Created:	Created By:	Description	Response Due:	Response from:	Response Rec'd:	Response Detail:	Status	Comments
D-1	04/30/24	RP	TI Sheets, sheet P20, waste and water for dishwasher?		MUSGROVE		MUSGROVE: This will be added in addendum #2.	Closed	
D-2	04/30/24	RP	TI sheets, are we missing a M20 sheet for HVAC floor plan for ducting?		MUSGROVE		MUSGROVE: Sheet M20 was accidentally left out. The printed sheet will be attached to the addendum.	Closed	
D-3	4/30/2024	SS	Training Addition Sheet AS21, Sheet Notes 02 41-07 calls out to demo and remove mechanical unit. Sheet M11, Key Not #1 calls out for mechanical unit to be retrofitted with a cooling unit. Please clarify.		MUSGROVE		MUSGROVE: Mechanical unit to be retrofitted not removed.	Closed	
D-4	05/09/24	SS	Dist 3 Building Improvement set indicates that sprinklers are in the TI project. Dist 3 TI Set Indicates Fire Sprinklers under separate permit. It appears that the D3 TI is primarily the 2nd floor area and the drawings indicate "No other Work" outside of that area. The Fire Sprinkler Plan P00 indicates that the fire sprinkler system will be designed and installed throughout the entire building. If sprinklers need to exist in the shop, contractor mentioned that city typically requires a structural verification showing (e) structure can handle added load of fire suppression system on building. Has this been completed? Also, if 1st and shop are getting fire sprinkler lines, are there old construction plans that can be provided showing structure, HVAC, Lighting, ceiling etc? Please clarify.				MUSGROVE: Fire sprinkler system is required. A performance specification will be provided, and a fire sprinkler contractor shall provide drawings as a deferred submittal. CSHQA: No "As Built's" are available, however we can share Previous constructions drawings. All dimensions should be verified in field prior to fabrication.	Closed	
D-5	05/09/24	SS	There is no fire sprinkler specification.		MUSGROVE		MUSGROVE: This will be added in addendum #2.	Closed	
D-6	05/13/24	SS	What is the existing pipe size at the point of connection for fire water service.		CSHQA		CSHQA: 12inch Per correspondance with City of Garden City.	Closed	
D-7	05/14/24	SS	Are there unheated/conditioned spaces in the T.I. building that would require a dry sprinkler system.	5/16/2024	CSHQA		CSHQA: See Existing building drawings included with Addendum 2. Provide dry pipe/system as required.	Closed	
D-8	05/14/24	SS	Please provide structural information on the existing building for design and installation for the new sprinkler system.	5/16/2024	CSHQA		CSHQA: No "As Built's" are available, however we can share Previous constructions drawings. All dimensions should be verified in field prior to fabrication.	Closed	

E - Electrical									
Item #	Date Created:	Created By:	Description	Response Due:	Response from:	Response Rec'd:	Response Detail:	Status	Comments
E-1	05/02/24	SS	Is Safety/Security scope of work to be by Owner, furnish and installed with rough-in to be included in the Electrical Contractor's scope of work? Please clarify.	5/16/2024			MUSGROVE: Correct, rough-in only is included in the Electrical Contractor's scope of work.	Closed	

F - Architectural									
Item #	Date Created:	Created By:	Description	Response Due:	Response from:	Response Rec'd:	Response Detail:	Status	Comments
F-1	04/26/24	SS	Roofing specifications call for coverboard, roof type assembly per R01 sheet G71 does not show coverboard. Is coverboard required?		CSHQA		CSHQA: COVERBOARD IS REQUIRED.	Closed	

Item #	Date Created:	Created By:	Description	Response Due:	Response from:	Response Rec'd:	Response Detail:	Status	Comments
F-2	04/26/24	SS	Are the door keypads Owner provided, Contractor installed?		CSHQA		CSHQA: CORRECT	Closed	
F-3	04/26/24	SS	Door schedule for the training bldg. sheet A82, door type C says solid core wood, the schedule below calls out type C door but material says Alum on door 101 and 102, HM on 105B, 117b Alum. Is this correct?		CSHQA		CSHQA: SEE REVISION TO DOOR SCHEDULE ON SHEET A82 IN ADDENDUM 2	Closed	
F-4	04/26/24	SS	Spec section 068316 - FRP Training Addition. Is FRP used on this project?		CSHQA		CSHQA: NOT NEEDED FOR TRAINING ADDITION	Closed	
F-5	04/26/24	SS	Spec section 099600 - HPC Training Addition. Is HPC used on this project?		CSHQA		CSHQA: HPC IS USED FOR EXTERIOR STEEL STAIRS AND LADDERS ONLY	Closed	
F-6	04/26/24	SS	T.I. Plans, Sheet A81. (1) Room Finish Schedule calls out APC1 at bathrooms, APC1 is missing from the Materials Key. (2) What is T1 for janitors closet wall, intended to be tile or FRP? Do we want on more then just north wall? (3) Corner guards aren't called out on A11.1. (4) Duplicate 208 rm, and storage room ceiling seems wrong per RCP		CSHQA		CSHQA: SEE UPDATED DRAWING IN ADDENDUM 2 (1) RRESTRROOM CEILINGS TO BE GYP. (2) JANITORS CLOSET TO HAVE FRP SURROUND AT EITHER SIDE OF MOP SINK. NO WALL TILE. (3) PROVIDE CONER GUARDS ON ALL EXPOSED CORNERS VERIFY LOCATIONS WITH ARCHITECT PRIOR TO PURCHASING. (4) PRINT ROOM #HAS CHANGED TO 231. STORAGE RM 208 TO BE OPEN TO STRUCTURE.	Closed	
F-7	04/26/24	SS	T.I. Plans, Sheet A83, Door Schedule, missing several Frame Types and Hardware sets. Please clarify.		CSHQA		CSHQA: SEE UPDATED DRAWING IN ADDENDUM 2	Closed	
F-8	04/26/24	SS	T.I. Plans, Sheet A83, Door Schedule, missing Door Type N. Please clarify.		CSHQA		CSHQA: SEE UPDATED DRAWING IN ADDENDUM 2	Closed	
F-9	04/29/24	SS	Sheet A51 calls out 0301-52 Concrete Wall Infill. Should this be updated to match 5 & 6/A72 CMU wall infill? Please clarify.		CSHQA		CSHQA: SEE 0422-06 ON SHEET A51 IN ADDENDUM 2	Closed	
F-10	04/30/24	RP	General note L on A23, Training Addition Plans, no detail for this in structural? Joists are @ 24" o.c.	5/16/2024			CSHQA: NO STEEL NESSICARY 2X BLOCKING AT PENETRATION EDGES IS SUFFICIENT FOR OPENINGS BETWEEN JOISTS. COORDINATE ANY OPENNIGS LARGER THAN 22" WITH JOIST MANUFACTURER.	Closed	
F-11	04/30/24	RP	General note F, A51, Training Addition Plans. I presume parapet on roof joists is adequate for screen walls?		CSHQA		CSHQA: NOT NEEDED FOR TRAINING ADDITION, PARAPET ADEQUATELY SCREENS MECH. EQUIPMENT AND PROVIDES NECESSARY FALL PROTECTION.	Closed	
F-12	04/30/24	RP	Sheet A10, Bldg Improv Plans, specs being called out on the drawing (07 33-06, 05 51-01) are missing clarifications under General Notes.		CSHQA		CSHQA: SEE REVISED SHEET A10 FOR ADDED KEYNOTE LIST INCLUDED IN ADDENDUM 2.	Closed	
F-13	04/30/24	RP	Sheet A72, Bldg Improv, references schindler pit ladder? Is this accurate		CSHQA		CSHQA: PIT LADDER TO BE PROVIDED BY CANTON, SEE A72-4	Closed	
F-14	04/30/24	RP	Sheet A82, Bldg Improv, do we want to have metal for door material 218 rather than re-use wood?		CSHQA		CSHQA: SEE REVISED SHEET A82 DOOR 218 MODIFICATION TO TYPE 'A' DOOR.	Closed	
F-15	04/30/24	RP	TI plans, sheet A22/A83. Looks like door 211 is used for room 209, and we are re-using door 210 ?		CSHQA		CSHQA: PLEASE SEE REVISED SHEET A83 IN ADDENDUM 2	Closed	
F-16	04/30/24	RP	TI Plans, sheet A32, appears we are missing (2) roller shade call outs. One should be north of GL-1 and one south of GL-1		CSHQA		CSHQA: ROLLER SHADES NOT NECESSARY AT WINDOWS	Closed	
F-17	04/30/24	RP	TI plans, A43, is callout H utilized?		CSHQA		CSHQA: CALLOUT H IS NOT UTILIZED	Closed	
F-18	04/30/24	RP	TI sheets, no architectural roof plan, do we need? Also, do we want walking pads on roof?		CSHQA		CSHQA: ADD WALKING PADS FROM EXISTING ROOF ACCESS HATCH TO AND AROUND MECHANICAL UNITS.	Closed	
F-19	05/02/24	SS	Missing Division 10 callouts and specs for the new bathrooms, ADA grab bars, toilet paper dispenser, paper towel dispenser, mirrors, etc. Please clarify.		CSHQA		CSHQA: SEE NEW SPEC SECTION IN ADDENDUM 2	Closed	
F-20	05/02/24	SS	Missing Flooring specs for walk off mat and LVT		CSHQA		CSHQA: SEE NEW SPEC SECTION IN ADDENDUM 2	Closed	
F-21	05/01/24	RP	Building improv/TI, Is there a ceiling for elevator room ?	5/16/2024			CSHQA:NO, OPEN TO STRUCTURE	Closed	
F-22	05/02/24	RP	Spec section missing for awning on T.I., 0730##		CSHQA		CSHQA: SEE NEW SPEC SECTION IN ADDENDUM 2	Closed	
F-23	05/02/24	RP	Detail for metal guardrail at (E) Stair 15S, T.I.		CSHQA		CSHQA: SEE NEW SPEC SECTION IN ADDENDUM 2	Closed	
F-24	5/13/2024	SS	Can you confirm that you are in fact looking for waterproofing at the elevator pit per details 2 & 3 of S1.05? Nothing listed in the specs or indicated in any other drawings.		CSHQA		CSHQA: YES, SEE NEW SPEC SECTION IN ADDENDUM 2	closed	
F-25	5/14/2024	SS	Sheet A10 Bldg. Improvements, call out A21-1, there is no sheet A21 or detail drawing in this set for the call-out.	5/16/2024	CSHQA		CSHQA: The Callout on Sheet A10 at the Stair will be corrected in the Addendum 02. This was the incorrect reference. A21 does not need to be in the set.	closed	



CONSTRUCTION MANAGERS · GENERAL CONTRACTORS

431 W. McGregor Dr., Boise, ID 83705
 P: 208.384.0800 | F: 208.345.5323 | www.cmcompany.com

Pre-Bid Meeting Agenda

ITD D3 Improvements and Addition

Meeting Date: Monday, May 13th, 2024
Time: 1:30 p.m.
Place: 8150 West Chinden Blvd. Garden City, Idaho
Purpose: Pre-Bid Meeting

ITEM	DESCRIPTION
	Please Sign In
1.0	Introductions
1.1	Owner: Idaho Transportation Department
	<ul style="list-style-type: none"> o Travis Frei – Facility Management Contract Officer o Tony Pirc – Facilities Program Manager o John Hall – District 3 Facilities Operations Manager
1.2	Architect: CSHQA
	<ul style="list-style-type: none"> o Andrew Lauda
1.3	Consultants
	<ul style="list-style-type: none"> o Civil Engineer – CSHQA – Jeff Ward o Structural Engineer – Axiom – Jared Brandau o Mechanical Engineer – Musgrove – Tod Nelson o Electrical Engineer – Musgrove – Kurt Lechtenberg
1.4	Construction Manager: CM Company
	<ul style="list-style-type: none"> o Sean Setterberg - Estimator o Erin Hoobing – Project Manager o Ryan Piper – Project Engineer o Chas Gregory – Superintendent
2.0	Review of Bid Requirements and Contract Forms
2.1	Plans – Printed plans are available from CM Company Inc. 431 W. McGregor Dr., Boise, Idaho, please give us at least 2 days’ notice. Plans are uploaded to AGC plan room as well as CM Company Dropbox and the ITD website. Bidding Contractors are responsible for all bidding and contract requirements listed in the specifications and CM Company’s Bidding Requirements.
2.2	Bid Format – This is a Construction Manager as Advisor. CM Company has a CMA contract with ITD. All trades will be under a prime contract with the Owner ITD.
2.3	Licensing – All Contractors must possess a Public Works Contractors license at time of bid.

2.4	<p><u>Bid Envelope</u> – The bid must be submitted in a sealed envelope. The envelope must be labeled correctly with the bid package number. The envelope must include the following:</p> <ul style="list-style-type: none"> ○ Bidders must use the bid form included within the bid documents. Bid must be signed in ink with the name and mailing address of the bidder. ○ Scope of work followed as stated on the Bid Form ○ Bid Bond. ○ Include the Contractors Affidavit for Drug and Alcohol-Free Workplace document. ○ Please review Part A6 of the bid documents – Bidders Checklist.
2.5	<p><u>Add Alternates</u></p> <ul style="list-style-type: none"> ○ There is an Alternate in the Fencing and Gates Bid Package #4. The scope is called out on the Training Addition set, sheet C40.
2.6	<p><u>Location and Time of Bid</u> - Bids are due Thursday, May 23th, 2024. This will be a staggered bid opening, look to the Bid Package Index in the Bidding Requirements for bid due times. They are also shown at the top of each Bid Package Bid Form. Please deliver or mail bids to Idaho Transportation Department Office, Building 8 located at 11331 W Chinden Blvd., Boise, ID 83714. No bids will be accepted after the bid is closed. Bids cannot be emailed.</p>
2.7	<p><u>Bond Requirements</u> – A Bid Bond of 5% is required and to be included in the sealed envelope with the bid. A payment and Performance bond will be required to the awarded contractors and the cost of the bond is to be included in your base bid price.</p>
2.8	<p><u>Addendum</u> – Bidders will be required to acknowledge all addenda on the bid form. The first Addendum was issued on Friday the 10th. A final Addendum will be posted no later than Friday May 17th.</p>
2.9	<p><u>Insurance Requirements</u> – Insurance requirements refer to the prime contract AIA A132 included in Addendum #1.</p>
2.10	<p><u>Bidders Questions</u> – Questions need to be submitted in writing by end of day, Tuesday the 14th.</p>
2.11	<p><u>Bidding</u> – N/A</p>
2.12	<p><u>Bidder Pre-Bid Information</u> – All pre-bid RFI's (request for information) or substitution requests should be sent to seans@cmcompany.com.</p> <ul style="list-style-type: none"> ○ Substitution Requests will be reviewed by CM Company then sent to the Architect. ○ Questions will be reviewed by CM Company and forwarded CSHQA. Formal questions sent via email that affect the project scope will be answered and posted in the final addendum. <p><i><u>Please do not send this information directly to the Architect or Engineer. There is a process used by CM Company to issue, track responses and post this information properly in addendums.</u></i></p>
3.0	<p>Project Overview 1.) Design Team: Andrew Lauda</p>
3.1	<p>Temporary Facilities</p> <ul style="list-style-type: none"> ○ Reference Temporary Facilities and Controls in the specification General Conditions. ○ Trade Contractors will need to have provisions in your bid for items specific to your Work.
4.0	<p>Schedule</p> <ul style="list-style-type: none"> ○ General overview of Construction Schedule



Construction Managers
General Contractors
PWC-C-10654 Unlimited 1, 2, 3
RCE 1245
Oregon #62774, LBPR 6227
Washington #600 626 741

431 W. McGregor Dr.

Boise, Idaho 83705

208 384-0800

Sign In Sheet

Project: ITD D3 Improvements and Addition

Meeting Purpose: Pre-Bid Job Walk

Meeting Time & Date: May 13th - 1:30pm

Name (PLEASE PRINT)	Company / Email
Sean Setterberg	seans@cmcompany.com
Erin Hoobing	erinh@cmcompany.com
ANDREW LAUDA	CSTHQA andrew.lauda@eshqa.com
Tony Gonzales	Lacy Mechanical tonyg@lacyinc.com
Kyle Hall	Ryle @ HHelectricboise.com
ROB COLLINS	Rcollins@QETDatto.com
John Hall	John.Hall@ITD.Idaho.gov
TRAVIS FREN	travis.fren@itd.idaho.gov
Travis Dennis	Travis.Northwest91@gmail.com
Nate Gallagher	Thorpe Fire nate@thorpe.biz



Construction Managers
 General Contractors
 PWC-C-10654 Unlimited 1, 2, 3
 RCE 1245

431 W. McGregor Dr.

Oregon #62774, LBPR 6227
 Washington #600 626 741

Boise, Idaho 83705

208 384-0800

Sign In Sheet

Project: ITD D3 Improvements and Addition

Meeting Purpose: Pre-Bid Job Walk

Meeting Time & Date: May 13th - 1:30pm

Name (PLEASE PRINT)	Company / Email
Alex Powell	Veca Electric wtpowell@veca.com
Matt Marovich	Mountain States estimating@mountainstatesroofing.com
Kurt Lechtenberg	Musgrave Eng. and kurtl@musgravepa.com
VAR REEVE	SUNSHINE LANDSCAPE var@sunshinelandscape.net
Lonny Baer	LEA ELECTRIC lonny@leaelectric.com
Branden Nowlan / Gene Nowlan	Gulley Excavation and Utilities branden@gulleyexcavation.com
Edward Rebman	Harris erebman@harriscompany.com
Rick Allen	Window Covering Outlet rick@windowcoveringoutlet.com
Chris Dyke	Musgrave Engr chris@musgravepa.com
Elbe Dyke	Musgrave Engr. N/A.



Construction Managers
 General Contractors
 PWC-C-10654 Unlimited 1, 2, 3
 RCE 1245

431 W. McGregor Dr.

Oregon #62774, LBPR 6227
 Washington #600 626 741

Boise, Idaho 83705

208 384-0800

Sign In Sheet

Project: ITD D3 Improvements and Addition

Meeting Purpose: Pre-Bid Job Walk

Meeting Time & Date: May 13th - 1:30pm

Name (PLEASE PRINT)	Company / Email
Drew Murray	IRA-MAC Inc drew@ira-mac.com
Chris Romans	chris@acroofingid.com
DORAN HATRICK	DORAN.HATRICK@PAIDEMELHANILAU.COM
Bruce Field	Int-rod. Systems Inc brucefield@performer.com
Brannon Bezy	American Mechanical estimating@americanmechanical.net
BRODIE STENQUIST	TREASURE VALLEY FIRE BRODIE@TUVFIRE.COM
CHAD KULOW	Black Horn Concrete Chad@Blackhornconcrete.com
Kelly King	kelly.kingmechanical@outlook.com
Daniel Thompson	Veritas electric 208@gmail.com
Benito Smith Earl Lopez	SB CONCRETE ESTIMATOR@SB-CONCRETE



**PER OWNER, THIS BOX AND
CABLING IS OUT OF SERVICE -
CAN BE REMOVED AND
ABANDONED.**

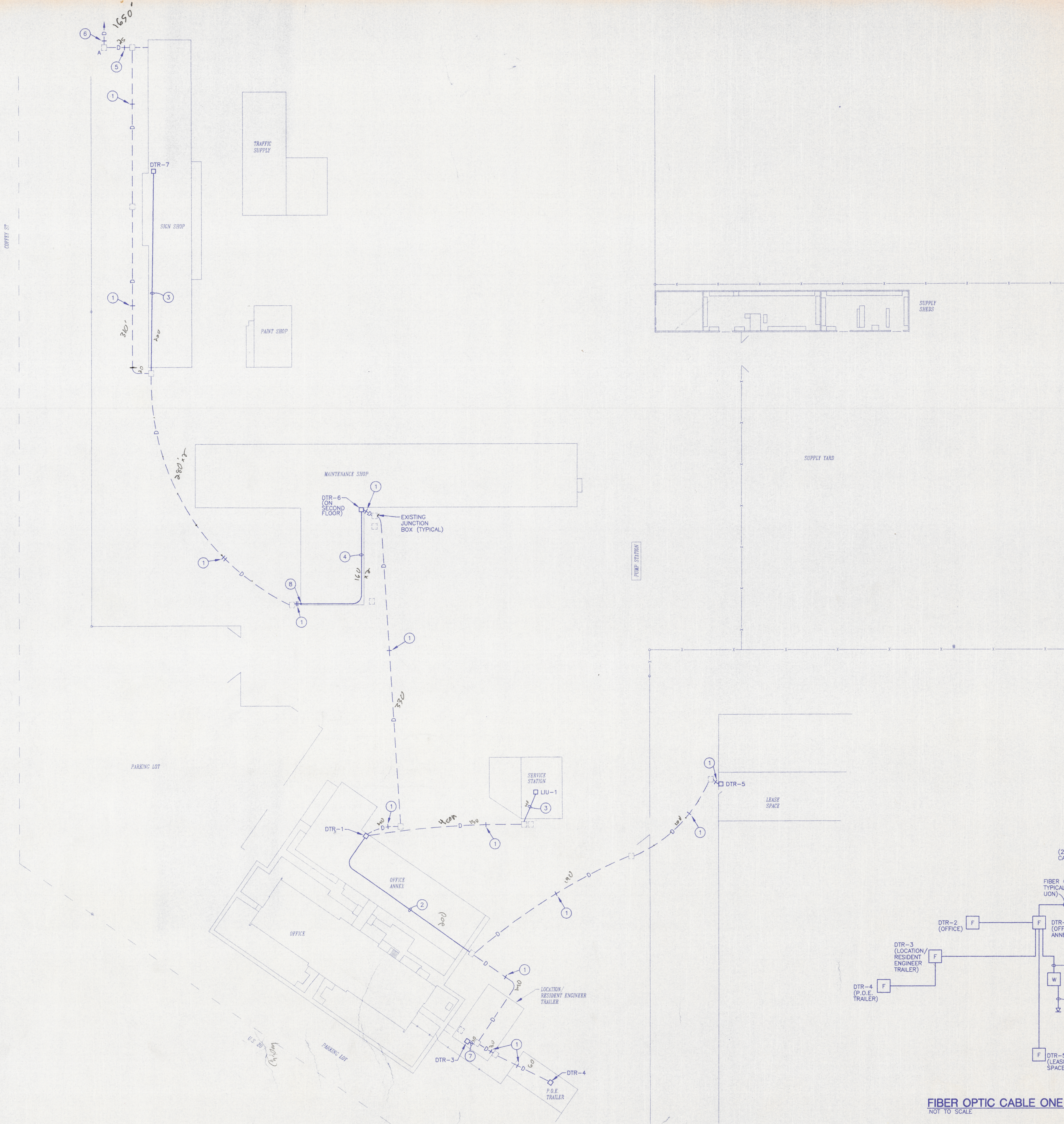

- KEYNOTES:**
- 1 FIBER OPTIC CABLE(S) IN EXISTING CONDUIT; REMOVE & REINSTALL EXISTING COMM. CABLES AS REQUIRED.
 - 2 FIBER OPTIC CABLES THRU CRAWL SPACE; VERIFY SUPPORTS & ROUTING.
 - 3 FIBER OPTIC CABLE FOLLOWING BUILDING STRUCTURE; VERIFY SUPPORTS & ROUTING.
 - 4 (2) FIBER OPTIC CABLES FOLLOWING BUILDING STRUCTURE; VERIFY SUPPORTS & ROUTING.
 - 5 FIBER OPTIC CABLE(S) IN EXISTING CONDUIT.
 - 6 FIBER OPTIC CABLE IN EXISTING CONDUIT TO EXISTING JUNCTION BOX AT FUTURE MULTI-PURPOSE BUILDING LOCATED APPROX. 800' NORTH OF JUNCTION BOX LABELED 'A'; VERIFY LOCATION. COIL 150' OF FIBER OPTIC CABLE IN EXISTING JUNCTION BOX AT FUTURE MULTI-PURPOSE BUILDING AND THEN INSTALL FIBER OPTIC CABLE IN EXISTING CONDUIT TO DTR-8 IN MAINTENANCE BUILDING LOCATED APPROX. 690' NORTH. SEE FIBER OPTIC CABLE ONE LINE DIAGRAM ON THIS SHEET.
 - 7 TWO FIBER OPTIC CABLES UNDER TRAILER FLOOR; VERIFY SUPPORTS & ROUTING.
 - 8 12" x 12" x 6"D NEMA '3R' JUNCTION BOX CONNECTED TO EXISTING UNDERGROUND CONDUIT STUBBED UP ONTO BUILDING; VERIFY LOCATION. PROVIDE & INSTALL FIBER OPTIC CABLE IN 1" CONDUIT TO A HEIGHT OF 10' INSIDE BUILDING.

ELECTRICAL SYMBOLS LIST (DISTRICT #3)

SYMBOL	DESCRIPTION
⊘	DATA OUTLET WITH (2) DATA CONNECTORS
⊘ ⁴	DATA OUTLET WITH (4) DATA CONNECTORS
-D-1	DATA CONDUIT (3/4" UON) WITH DATA CABLES (DENOTED BY SLASH LINES) TO RESPECTIVE DATA TERMINAL RACK INDICATED. 1" CONDUIT SHALL BE USED WHERE 4 DATA CABLES ARE INDICATED.
F	RESPECTIVE DATA TERMINAL RACK; F-FLOOR MOUNTED, W-WALL MOUNTED
W	RESPECTIVE DATA INTERCONNECTION UNIT (LIU), WALL MOUNTED
⊘	DOUBLE DUPLEX RECEPTACLE
⊘	DUPLEX RECEPTACLE
UON	UNLESS OTHERWISE NOTED
①	KEYNOTE NUMBER

ELECTRICAL SYMBOLS LIST GENERAL NOTES:
 1. EXISTING ITEMS INDICATED WITH SHORT DASHED LINES.
 2. MATCH EXISTING HEIGHTS.

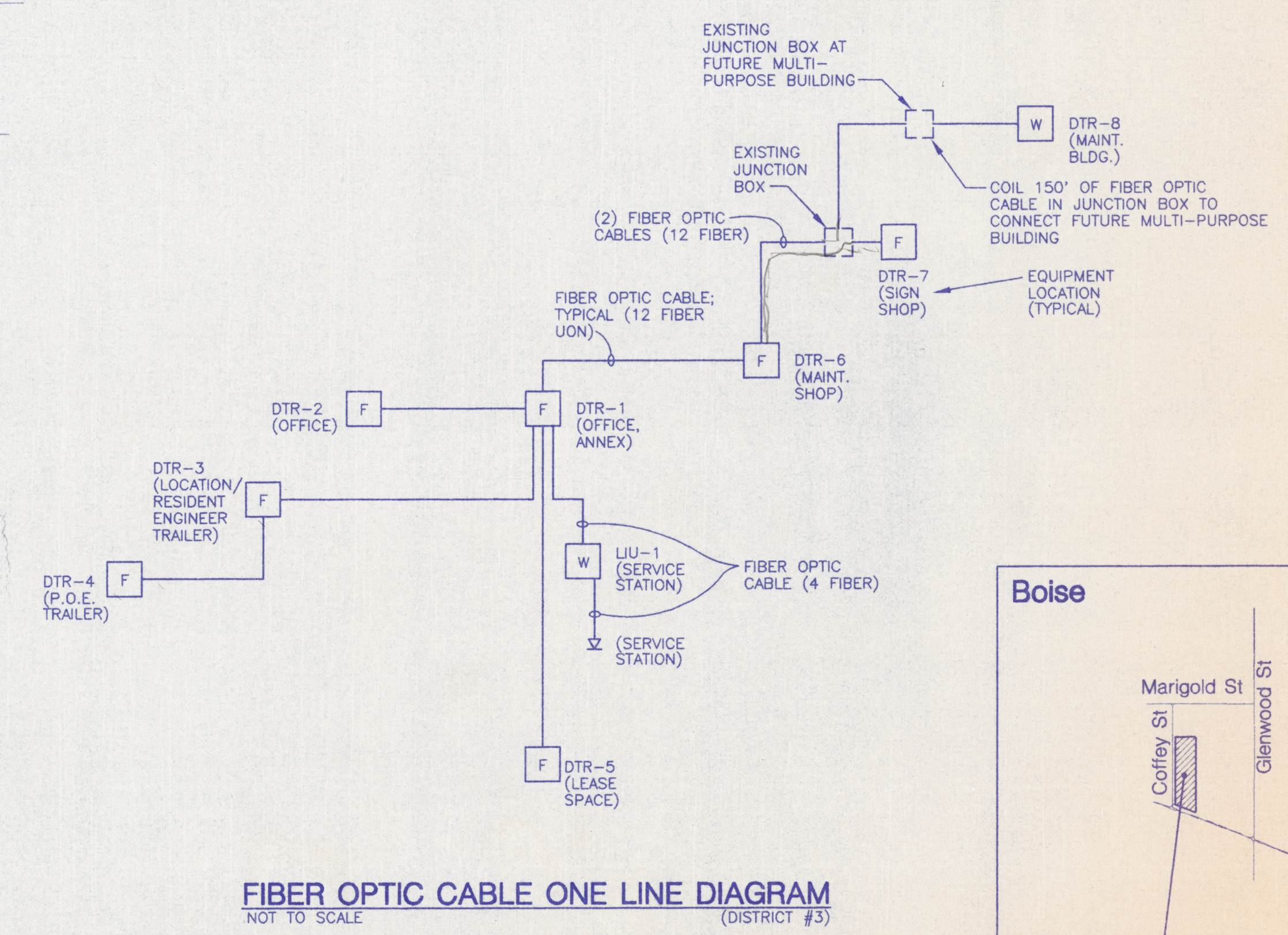

FIBER OPTIC CABLE ONE LINE DIAGRAM
 NOT TO SCALE (DISTRICT #3)

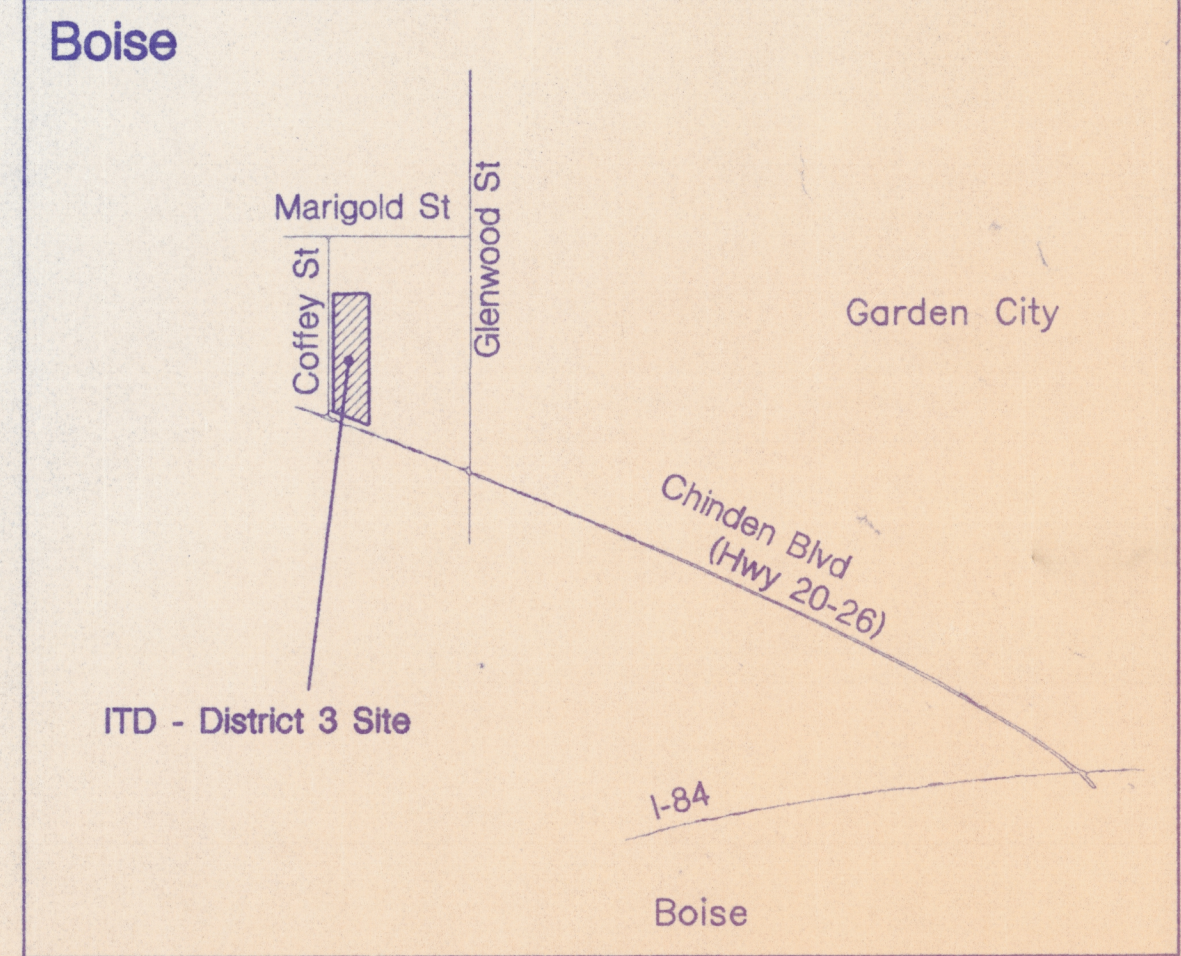

DISTRICT #3 - SITE DATA PLAN
 SCALE: 1"=40'-0"



EJ AND ASSOCIATES
 CONSULTING ENGINEERS
 815 PARK BOULEVARD, SUITE 230
 BOISE, IDAHO 83712-7739
 Phone (208)345-7127 FAX (208)345-7173

CRI the resource group
 CRI/The Resource Group
 COMPUTER CONSULTING & NETWORK SERVICES
 P.O. Box 8183
 Boise, ID 83707
 208-343-9192
 Fax 208-343-2588

STATE OF IDAHO
TRANSPORTATION DEPARTMENT
DISTRICTS NETWORKING PROJECT
 D.P.W. PROJECT NUMBER 96-570
 DISTRICT #3 - SITE DATA PLAN

3

LOCATION: BOISE, IDAHO

DATE: APRIL 1996
 DRAWN BY: D.M.E. CHECKED BY: M.C.M.
 ES&M & ASSOC. PROJECT NO. 95-091

REVISION: _____ DATE: _____

SHEET NO. **3-E1**
 OF _____ SHEETS