

NOTES

- EXISTING PLANS ARE AVAILABLE AT THE RESIDENT ENGINEER'S OFFICE.
- PATCH AND REPAIR CONCRETE IN ACCORDANCE WITH 582 EXCEPT CONCRETE REMOVAL MUST BE TO A MINIMUM DEPTH OF 3/4" BELOW THE OUTER LAYER OF REINFORCEMENT.
- EXERCISE CARE DURING CONCRETE REMOVAL TO PREVENT ADDITIONAL DEBONDING OF REINFORCEMENT.
- DO NOT REMOVE CONCRETE IN ANY AREA WITHIN 1/2" OF GIRDER BEARING SYSTEMS INCLUDING NEOPRENE PADS AND LEAD PLATES FOR THE FULL DEPTH OF THE PIER CAP, EXCLUDING THE BOTTOM 4" OF THE PIER CAP. NOTIFY THE ENGINEER OF ANY UNSOUND CONCRETE FOUND WITHIN THIS AREA.
- PROGRESSIVELY REPAIR PIER CAPS TO MAINTAIN STRUCTURAL INTEGRITY UNDER TRAFFIC LOADING. EXPOSE NO MORE THAN 5' OF MAIN REINFORCEMENT AND NO MORE THAN 50% OF THE PERIMETER OF THE PIER CAP AT ANY GIVEN TIME.
- REPAIR CONCRETE SURFACE CRACK WIDTHS EXCEEDING 0.016" IN ACCORDANCE WITH 581.
- REPAIR QUANTITIES ARE APPROXIMATE. REPAIR ADDITIONAL DETERIORATED CONCRETE AREAS NOT SHOWN OR NOTED IN ACCORDANCE WITH 581 AND 582 AS DIRECTED.

TABLE OF ESTIMATED BRIDGE REPAIR QUANTITIES

LOCATION	581-005A CONCRETE CRACK REPAIR PREPARATION (FT)	581-010A CONCRETE CRACK EPOXY INJECTION (GAL)	582-005A PATCH & REPAIR CONC. SURFACE QUANTITIES (SF)	582-010A PATCH & REPAIR DECK CONC. SURFACE QUANTITIES (SF)
DECK/APPROACH SLABS				
GIRDERS/END DIAPHS.				
ABUTMENTS				
PIER CAPS				
RAILING				
TOTAL				

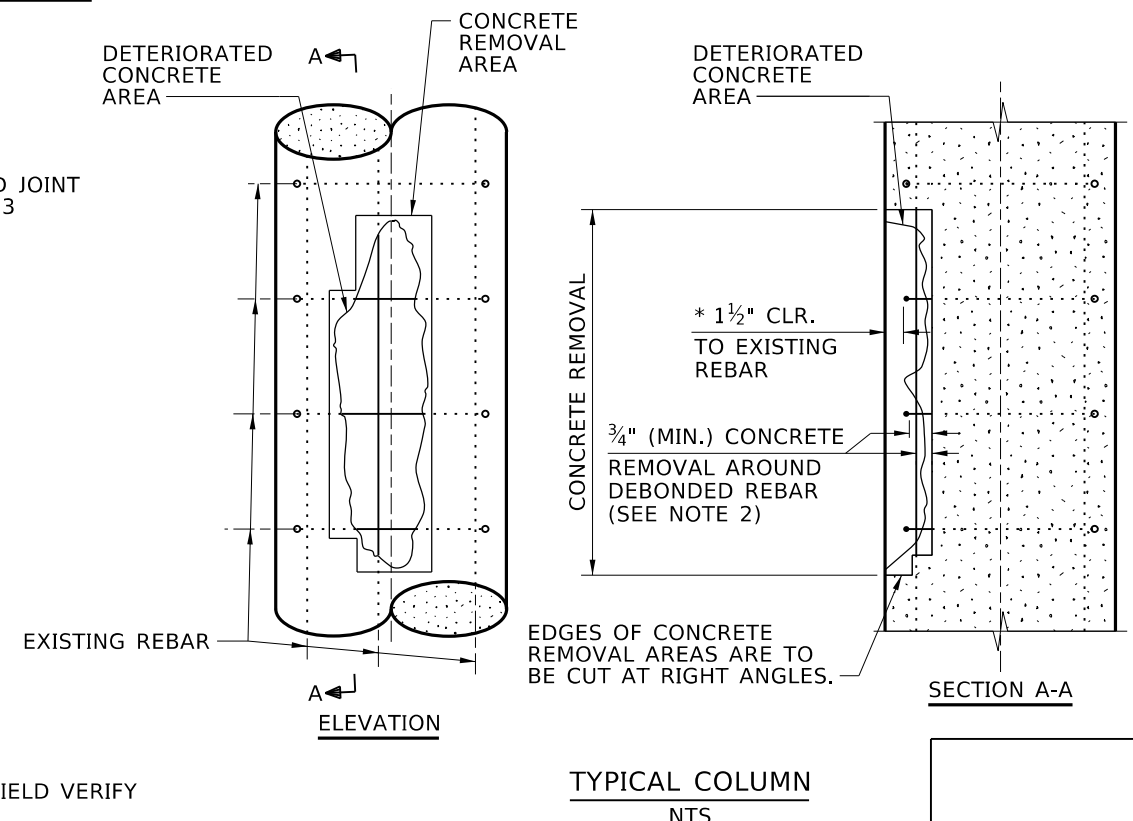
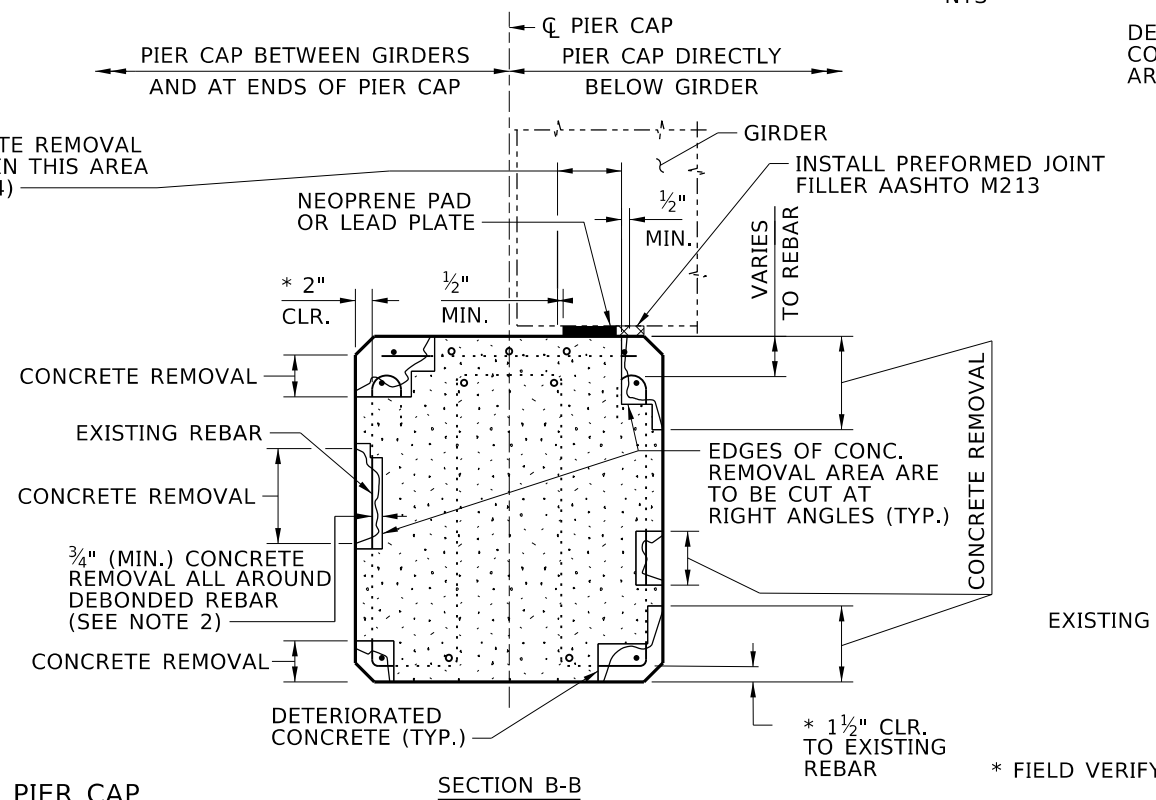
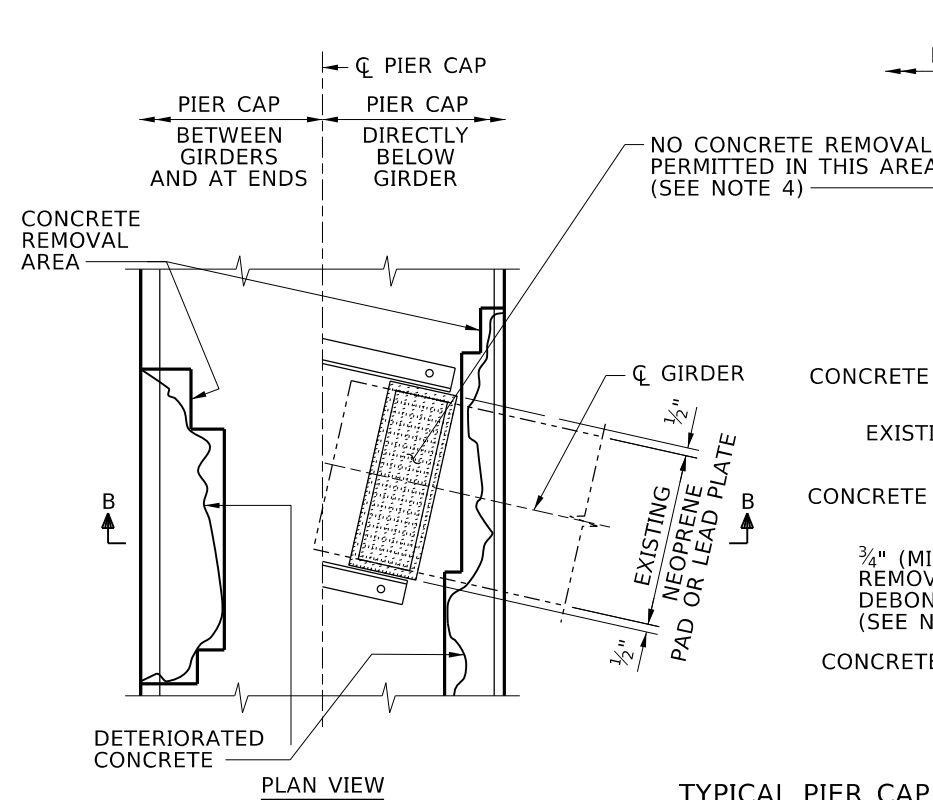
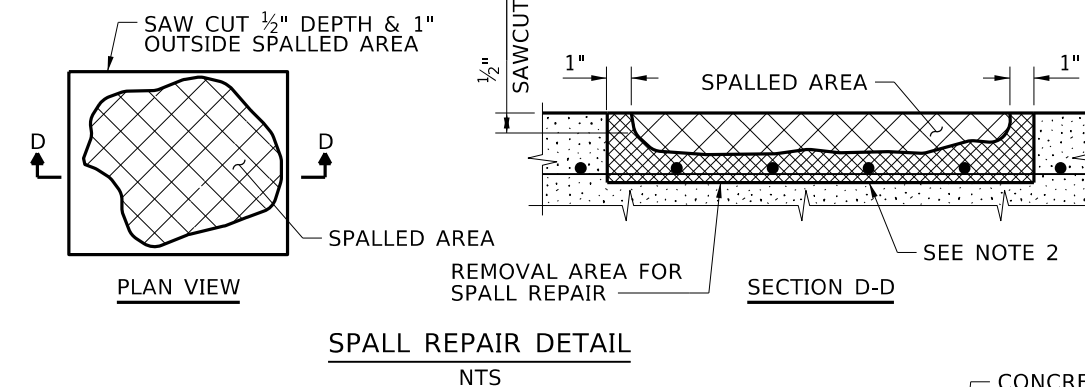

REVISIONS

NO.	DATE	BY	DESCRIPTION
▲			
▲			
▲			
▲			

DESIGNED

DESIGN CHECKED

DETAILED

DWG. CHECKED

CORRECTIONS

SCALES SHOWN ARE FOR 11" X 17" PRINTS ONLY

CADD FILE NAME

Standards/Bridge Standard Drawings/805_B.DGN

DRAWING DATE: OCT 2023

IDAHO TRANSPORTATION DEPARTMENT

YOUR Safety → YOUR Mobility → YOUR Economic Opportunity

APPROVED BY: BRIDGE ENGINEER MICHAEL T. JOHNSON DATE:

ENGLISH PROJECT NO.

CONCRETE REPAIR DETAILS

BRIDGE LRFD DESIGN MANUAL, B5.8

BRIDGE PLANS

BRIDGE KEY NO.

COUNTY KEY NO.

BRIDGE DWG. NO. SHEET OF