



SH-16/SH-44 Interchange

Pre-Advertisement Presentation

March 13, 2025
2:30pm (MST)

Your Safety • Your Mobility • Your Economic Opportunity

Agenda



- Safety Topic
- Welcome Remarks
- Introductions
- SH-16/SH-44 Interchange Project Overview and Scope
- Key Dates and Timeframes
- Questions

FOR INFORMATIONAL PURPOSES ONLY.
NOT FOR BIDDING.



Safety Topic

Construction Site Safety Rules

Always wear PPE



Do Not Enter



Follow Signs

Report

Use the Right Equipment



If in Doubt, ASK



Welcome



The Idaho Transportation Department is constructing a full interchange between SH-16 and SH-44 in Ada County starting in Summer 2025.



Team Introductions



Dan McElhinney

Chief Deputy Director/COO

Amy Schroeder

Division Administrator

Eric Staats

TECM Program Manager

Erika Bowen

TECM Engineer Manager

Jason Brinkman

District 3 Division Administrator

Shawna King

Design/Construction Engineering Manager

Andrew Linder

Design Construction 1 Resident Engineer



Disclaimer



- The information in the following slides is presented to the contracting community to increase awareness of the upcoming advertisement of the SH-16/SH-44 Interchange project.
- Information within these slides are not contractual.
- The only contractually binding materials are the bid documents when the project is advertised.
- All quantities are approximate and subject to change prior to advertisement.



Project Location

District 3

City of Star

City of Eagle

Ada County

Ada County Highway District

SH-44

- Approximately 1 mile

SH-16

- Approximately 1 mile

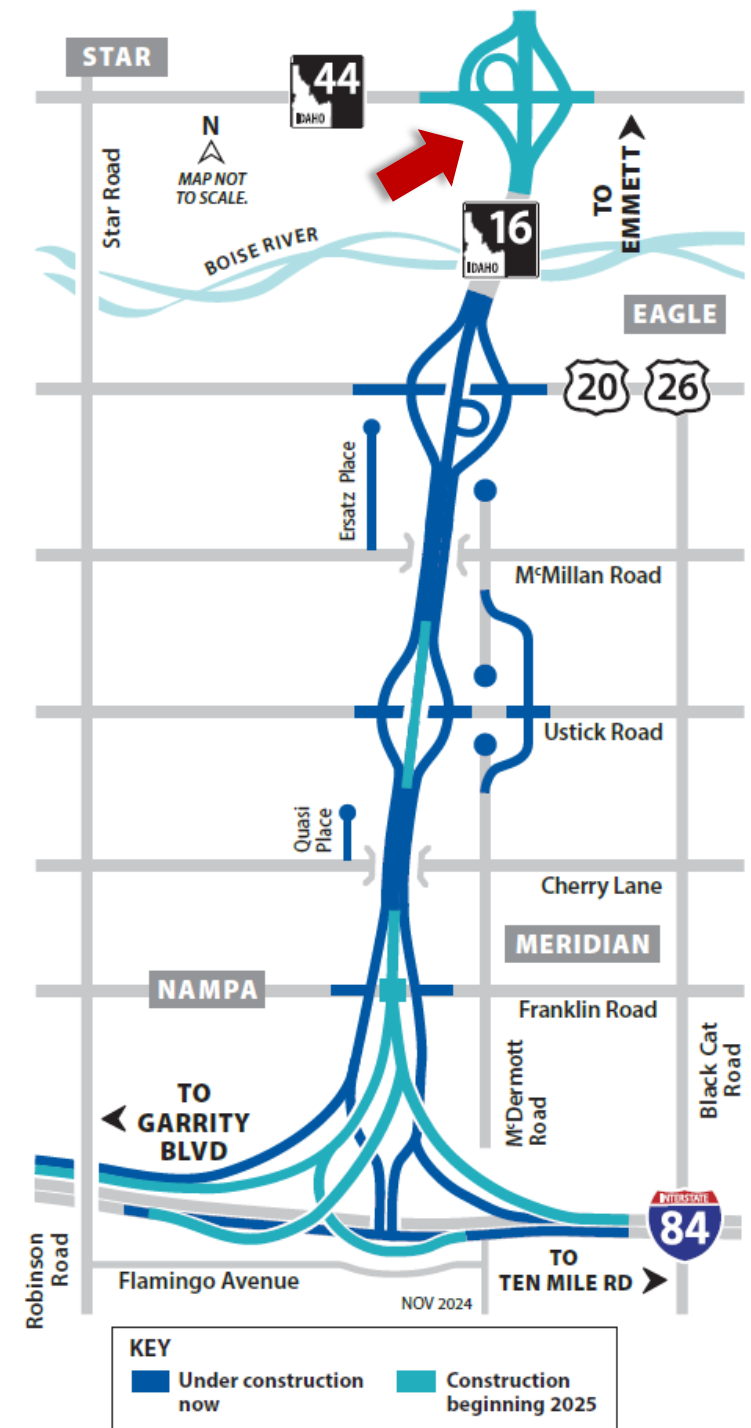

Project Overview



Anticipated Advertisement

- May/ June 2025
- Four (4) week advertisement

Estimated Construction Budget

- \$65-\$75M

Federally Funded Construction

- 7% DBE Goal
- Davis-Bacon
- Buy America

Construction Duration

- 1.5 - 2 years (Start: Summer 2025; Complete: Spring 2027)



Proposed Improvements

Roadway Improvements

- The new interchange design is a partial cloverleaf
- A 10ft pathway will be constructed on the south side of State Highway 44

Bridges

- State Highway 16 over State Highway 44
- Precast box culvert at Little Pioneer Canal

SH-44 Access Changes

- Combination of signalized intersections and limited access to local roads

Construction Staging

- Multi-year, multi-phased, and multi-contractor coordination

Roadway Improvements

Approximate Quantities

- 415,000 CY Granular Borrow
- 39,000 TON Granular Subbase
- 92,000 TON ¾" Aggregate
- 106,000 SY 10" Concrete Pavement
- 30,000 TON HMA Pavement
- 9,400 FT Concrete Barrier

SH-44

Typ. Section

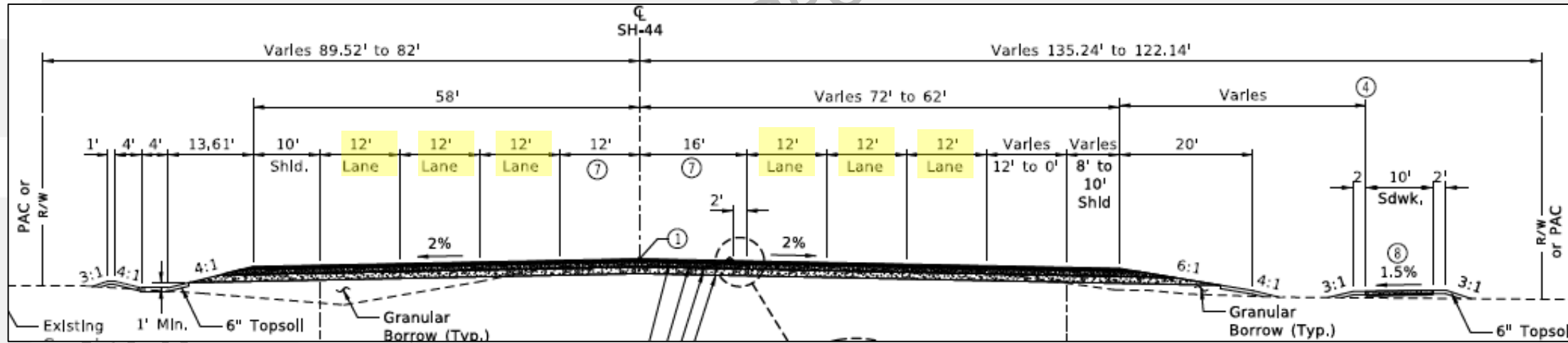

SH-16

Typ. Section

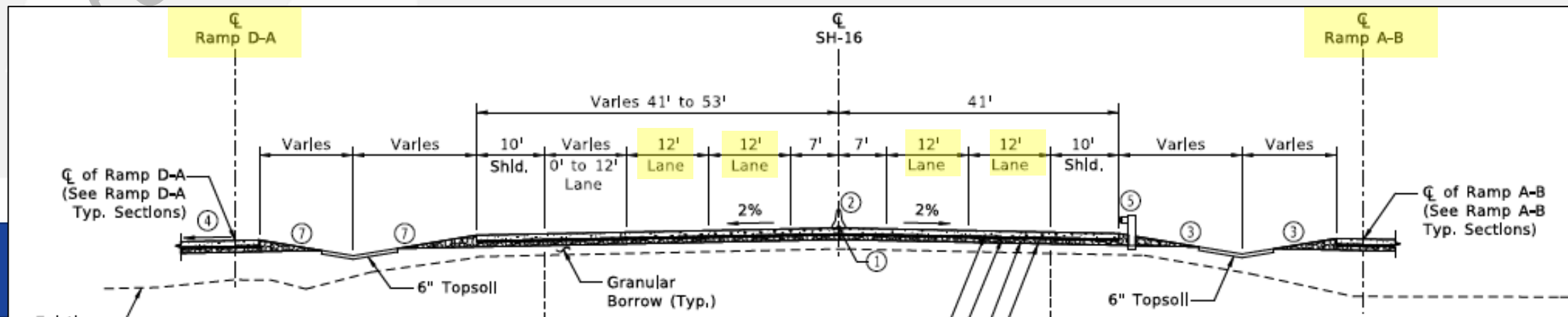

Bridge Improvements

Improvements:

- 176ft steel plate girder bridge over SH-44
- 495ft concrete box culvert ~ Little Pioneer Canal

Approximate Quantities

- 2 OH Bridge Sign Structures
- 2 OH Sign Structures
- 3 OH Cantilever Sign Structures
- 1 Steel Bridge (950,000 lb)
- 1 Precast Concrete Culvert
- 6,400 SF MSE Retaining Wall

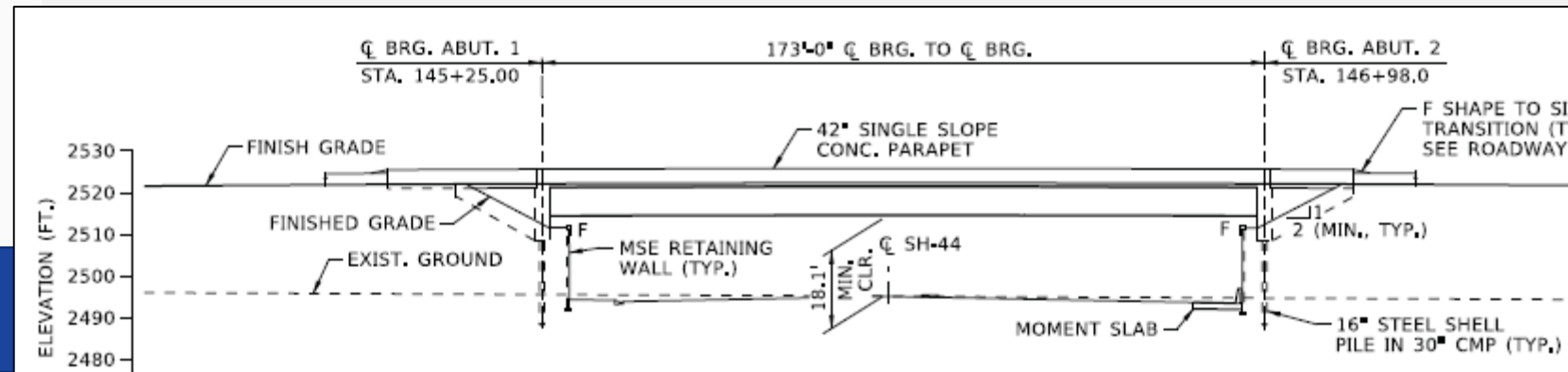
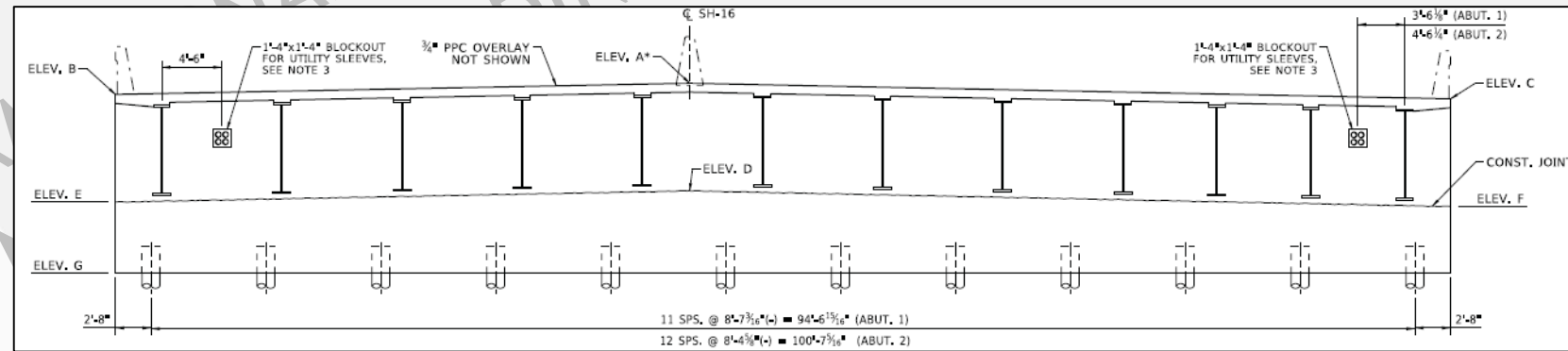
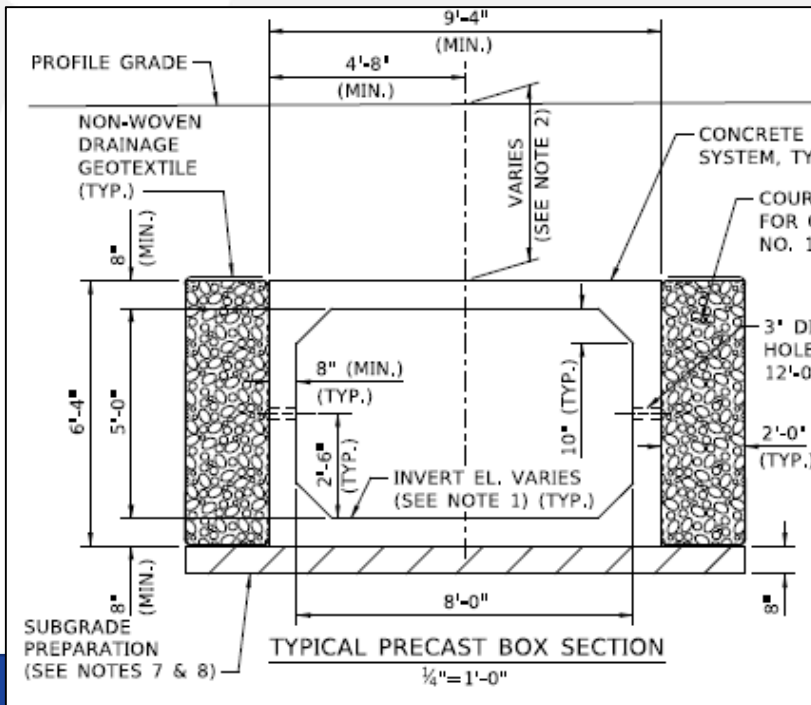

SH-44 Access Changes

West of the Interchange:

- Moyle Avenue will be fully signalized
- Crystal Springs Lane will be right-in, right-out
- Dawes Place will be a gated access point for emergency responders

East of the Interchange:

- Hamlin Road will be right-in, right-out
- Short Road will be right-in, right-out, left-in

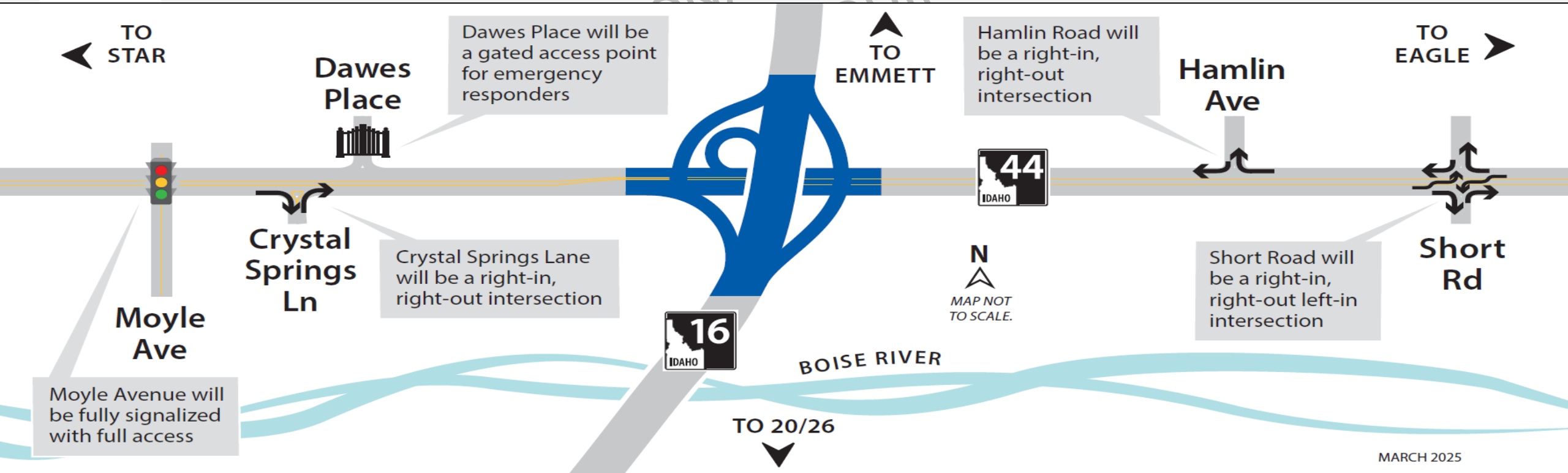

Lane Closures and Restrictions



- Day and night work allowed
- Maintain at least one lane of travel in each direction on SH-16 and SH-44 at all times except during allowed closures.
- SH-44 Full Closure
 - A total of eight (8) full closures of SH-44 eastbound and westbound between SH-16/SH-44 Ramp AB and BC intersection and Plummer Road (10pm - 5am)
- SH-16 Northbound Closure
 - A total of four (4) full closures of northbound SH-16 (10pm - 5am)



Construction Phasing

Stage 0

- Temporary paving along SH-44 and SH-16

Stage 1

- Construct SH-16 northbound outside lane and outside shoulder
- Construct Ramp AB and south side of SH-44
- Construct portion of Little Pioneer Canal box culvert beneath Ramp AB

Stage 2

- Reconstruct inside shoulder and lane in both directions on SH-16

Stage 3

- Construct ramp BC, north side of SH-44, and east side of SH-16
- Construct signal pole and foundation in SH-44 median

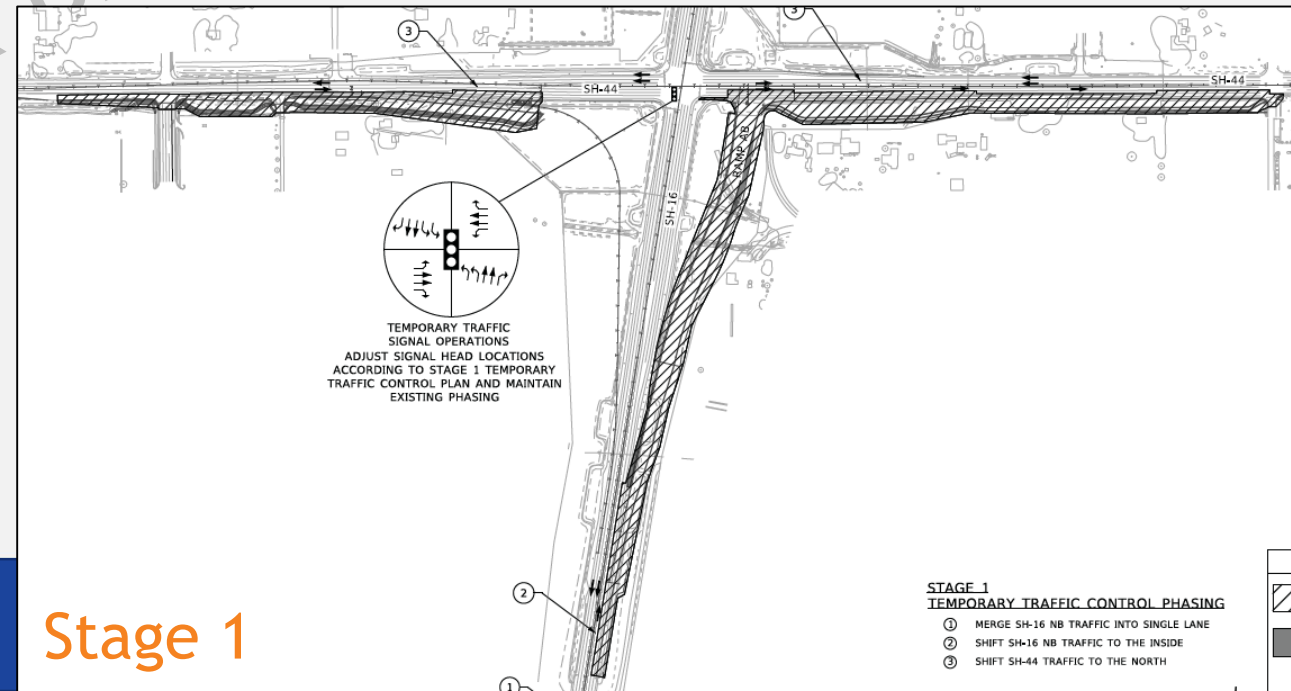

Stage 1

Construction Staging

Stage 4

- Construct SH-16 bridge over SH-44
- Install culvert north of SH-44
- Install overhead sign structures
- Construct Ramps CD, DA, and loop ramp
- Construct remaining portion of Little Pioneer Canal box culvert

Stage 5

- Construct SH-44 eastbound lanes, Ramp AB, and SH-16 median barrier and curbed islands

Stage 6

- Construct SH-44 median and inside lanes
- Construct sidewalk ramp and medians
- Remove all remaining temporary pavement

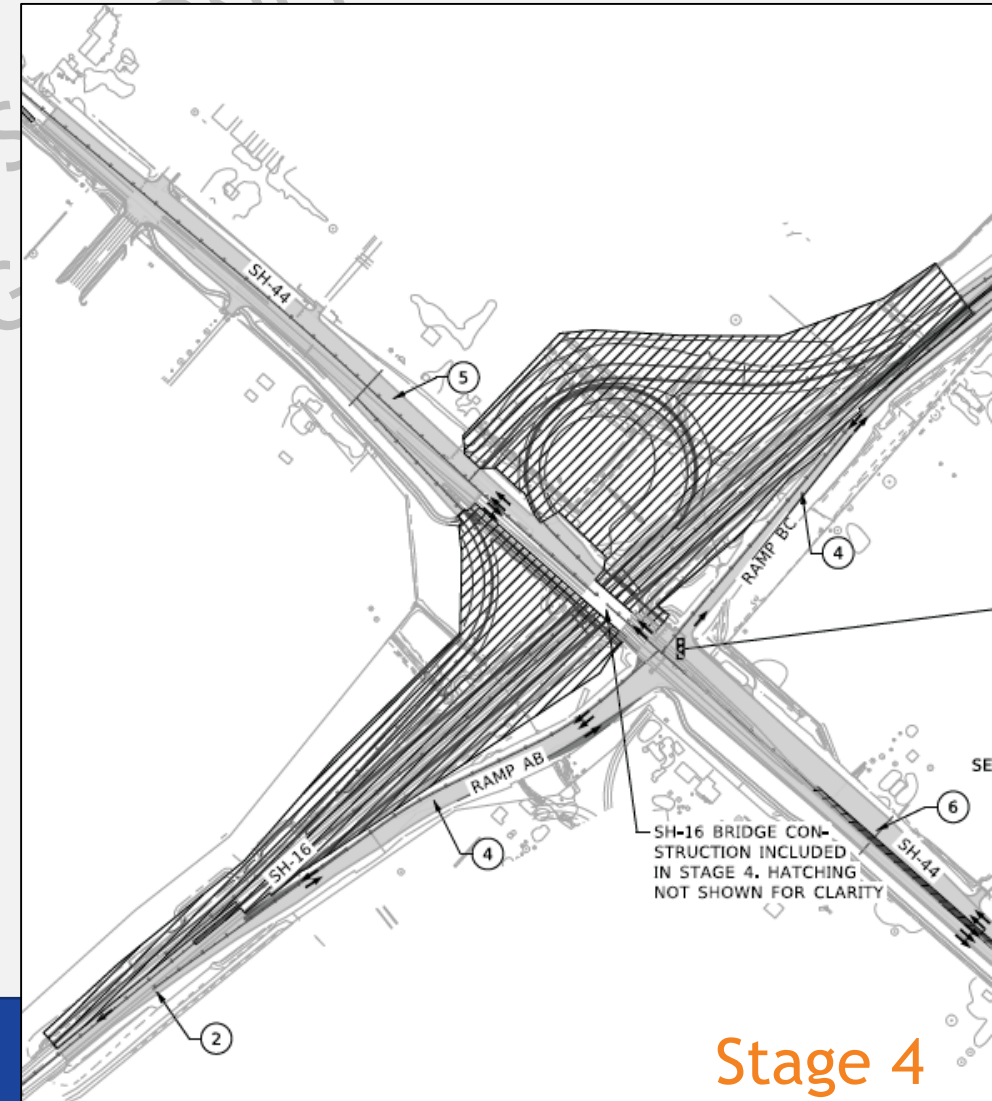

Adjacent Projects

SH-16, I-84 to US-20/26

- **NORTH (Ustick to US 20/26)**
 - Dan Gorley - ITD Resident Engineer
- **CENTRAL (Franklin Rd to Ustick Rd)**
 - Dan Gorley - ITD Resident Engineer
- **SOUTH (System IC and Franklin IC)**
 - Jeff Ryan - ITD Resident Engineer



Construction Schedule

SH-16/SH-44 Interchange

Anticipated Advertisement

- May/June 2025
- Four (4) week advertisement

Construction Begins

- Summer 2025

Work Complete

- Spring 2027

State
Highway 16



Interchange



Specification Highlight

Section 629 - Mobilization

“After contract award, and upon written request by the Contractor, the Department will issue the first progress payment up to 20 percent of the contract unit price or 2 percent of the total contract amount, whichever is less. Productive work on the project is not required for this payment.”
(629.05 Basis of Payment)



Specification Highlight



Section 104 - Construction Partnering

Formal partnering is specified for this contract. The purposes of Construction Partnering are:

- To enhance project and work zone safety
- To produce customer-focused results
- To use innovative problem solving
- To overcome extraordinary challenges
- To effectively administer the contract
- To provide timely completion of projects

FOR INFORMATIONAL PURPOSES ONLY.
NOT FOR BIDDING.



Contact Information



Project Website <https://itdprojects.idaho.gov/pages/sh16corridor>

ITD Design Contact:

Erika Bowen

Engineer Manager, Design

erika.bowen@itd.idaho.gov

208-265-4312 ext. 7

ITD Construction Contact:

Andrew Linder

Resident Engineer, Design/Construction Group 1

Andrew.Linder@itd.idaho.gov

208-334-8331

