

SECTION THRU WALLS & TOP SLAB
1"=1'-0"

NOTES:

1. PROVIDE EXPANSION JOINTS SHOWN ON THE PLANS.
2. PROVIDE CONSTRUCTION JOINTS WITH A MAXIMUM SPACING OF 40 FEET.
3. LOCATE NO CONSTRUCTION JOINT CLOSER THAN 40 FEET TO AN EXPANSION JOINT.
4. PROVIDE WATERSTOPS IN PEDESTRIAN TUNNEL JOINTS.
5. CONTRACTION JOINTS MAY BE SUBSTITUTED FOR CONSTRUCTION JOINTS IN THE WALLS.

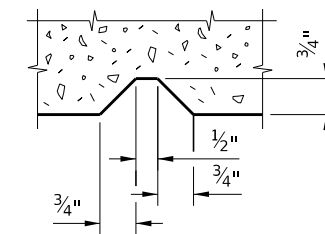

CONTRACTION JOINT
(TYP. FOR BOTH SIDES
OF CULVERT WALLS)
3" = 1'-0"

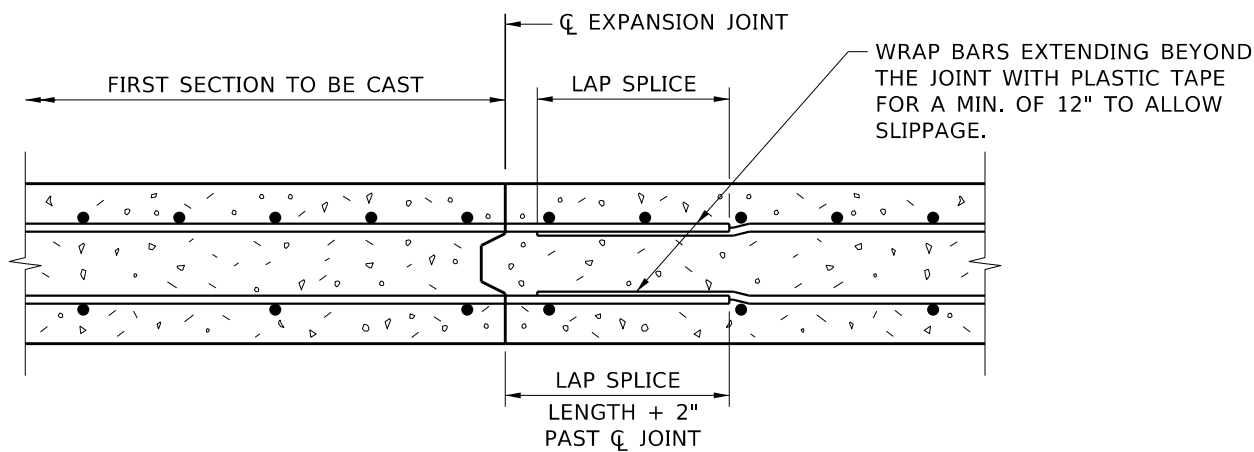

SECTION THRU BOTTOM SLAB
EXPANSION JOINT DETAILS
1"=1'-0"

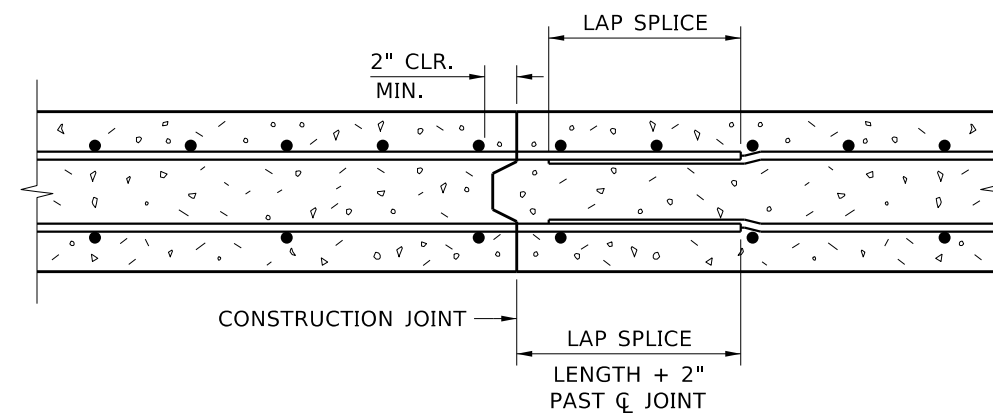

TYPICAL CONSTRUCTION JOINT
(TYPICAL @ SLABS AND WALLS)
1"=1'-0"

REVISIONS			
NO.	DATE	BY	DESCRIPTION

DESIGNED
DESIGN CHECKED
DETAILED
DWG. CHECKED
CORRECTIONS

SCALES SHOWN ARE FOR 11" X 17" PRINTS ONLY
CADD FILE NAME
Standards/Bridge Standard Drawings B12_1.DGN
DRAWING DATE: OCT 2023

IDAHO TRANSPORTATION DEPARTMENT

YOUR Safety → YOUR Mobility → YOUR Economic Opportunity

APPROVED BY: BRIDGE ENGINEER **MICHAEL T. JOHNSON** DATE: _____

ENGLISH
PROJECT NO.

CAST-IN-PLACE CULVERT JOINT DETAIL

BRIDGE LRFD DESIGN MANUAL, B12.1

BRIDGE PLANS	
BRIDGE KEY NO.	
COUNTY	KEY NO.
BRIDGE DWG. NO.	SHEET OF